

X500 USER MANUAL

1. RUNNING ENVIRONMENT	2
1.1 HARDWARE ENVIRONMENT	2
1.2 SOFTWARE ENVIRONMENT	2
2. SOFTWARE INSTALLATION.....	2
2.1 CLIENT DOWNLOADING	2
2.2 CLIENT SETUP	2
3. SOFTWARE ACTIVATION AND DOWNLOAD	4
3.1 SOFTWARE ACTIVATION	4
3.2 SOFTWARE DOWNLOADS.....	10
4. SOFTWARE INTRODUCTION.....	13
4.1 APP STORE	14
4.2 MAINTENANCE SERVICE.....	14
4.3 SETTING	15
4.3.1 Run Mode	15
4.3.2 VCI INFO.....	16
4.3.3 Updates	17
4.3.4 About	18
4.4 DTC QUERY.....	18
4.5 EXAMPLE	19
4.6 FEEDBACK.....	25
4.7.1 Image Managemant	26
4.7.2 APP Management	28
5. PRODUCTS WEBSITE	29
6. WARRANTY.....	29

1. Running Environment

1.1 Hardware Environment

Cellphone or PAD with Bluetooth. Space disk can't be less than 1G, and RAM can't be less than 512M.

Communication port: Wi-Fi or Bluetooth

1.2 Software Environment

Android 4.4 to 6.0

2. Software Installation

2.1 Client Downloading

Access the website: <http://www.tdintel.com/support>, and download "X500 Client.apk"

2.2 Client Setup

Run "X500 Client.apk":

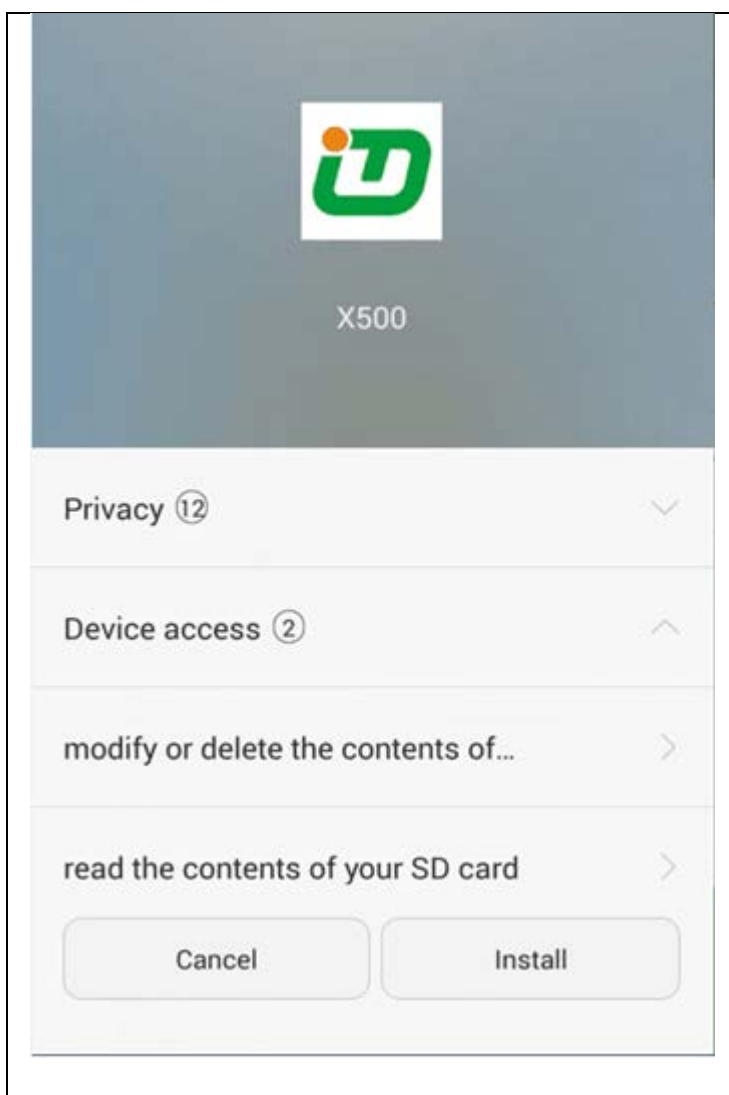

Please click "Install"

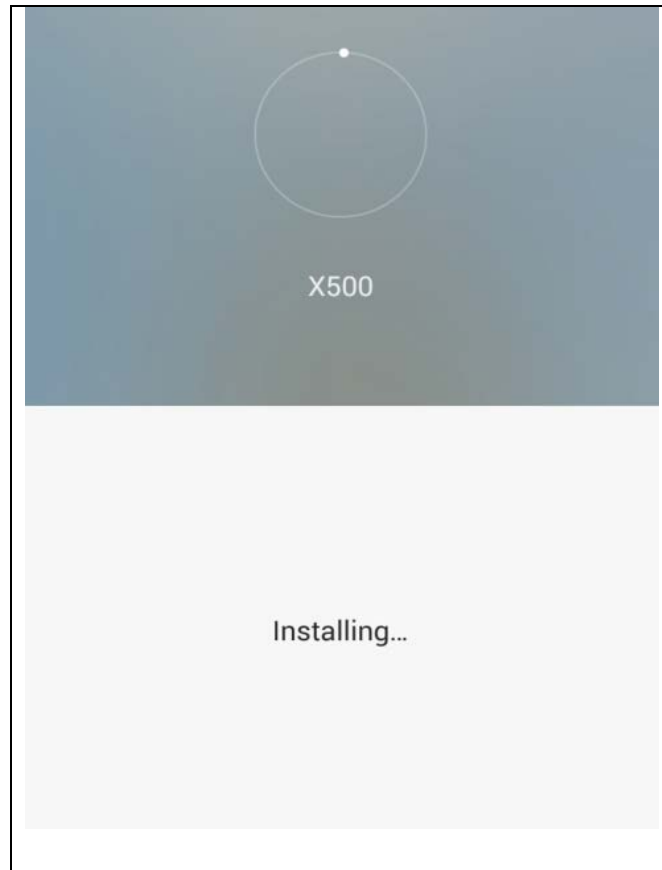

Please wait...

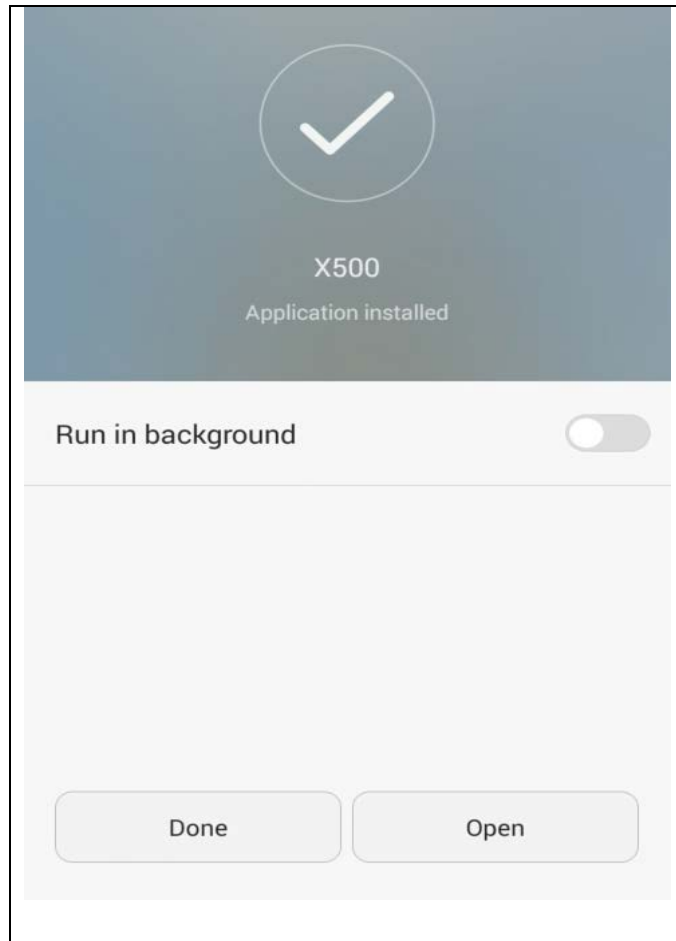

Installed successfully.

3. Software Activation and Download

3.1 Software Activation

At first, please keep network working. Run X500 APP, then click “App Store” to get applications.

XTUNER

Please wait...

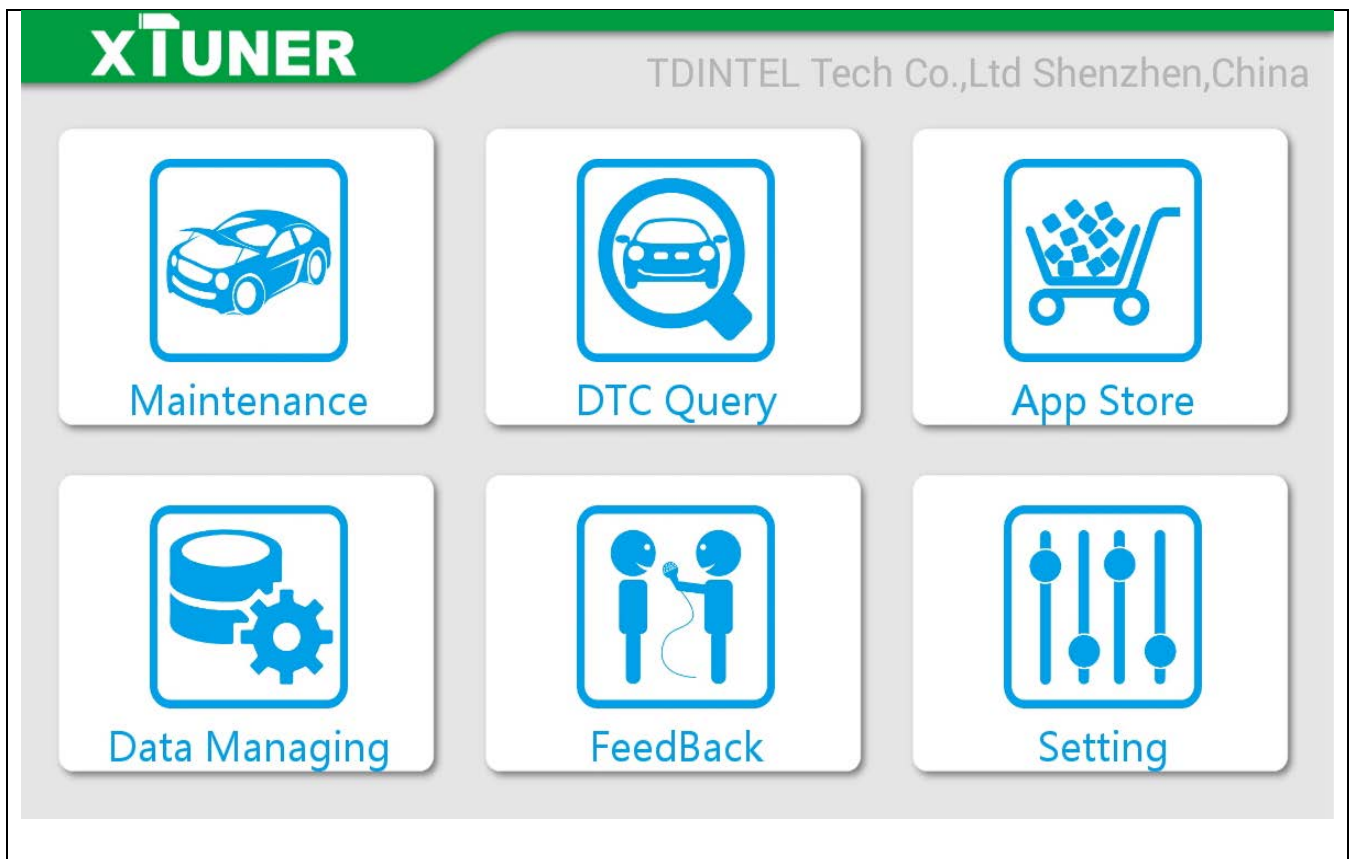

Please click “APP Store”.

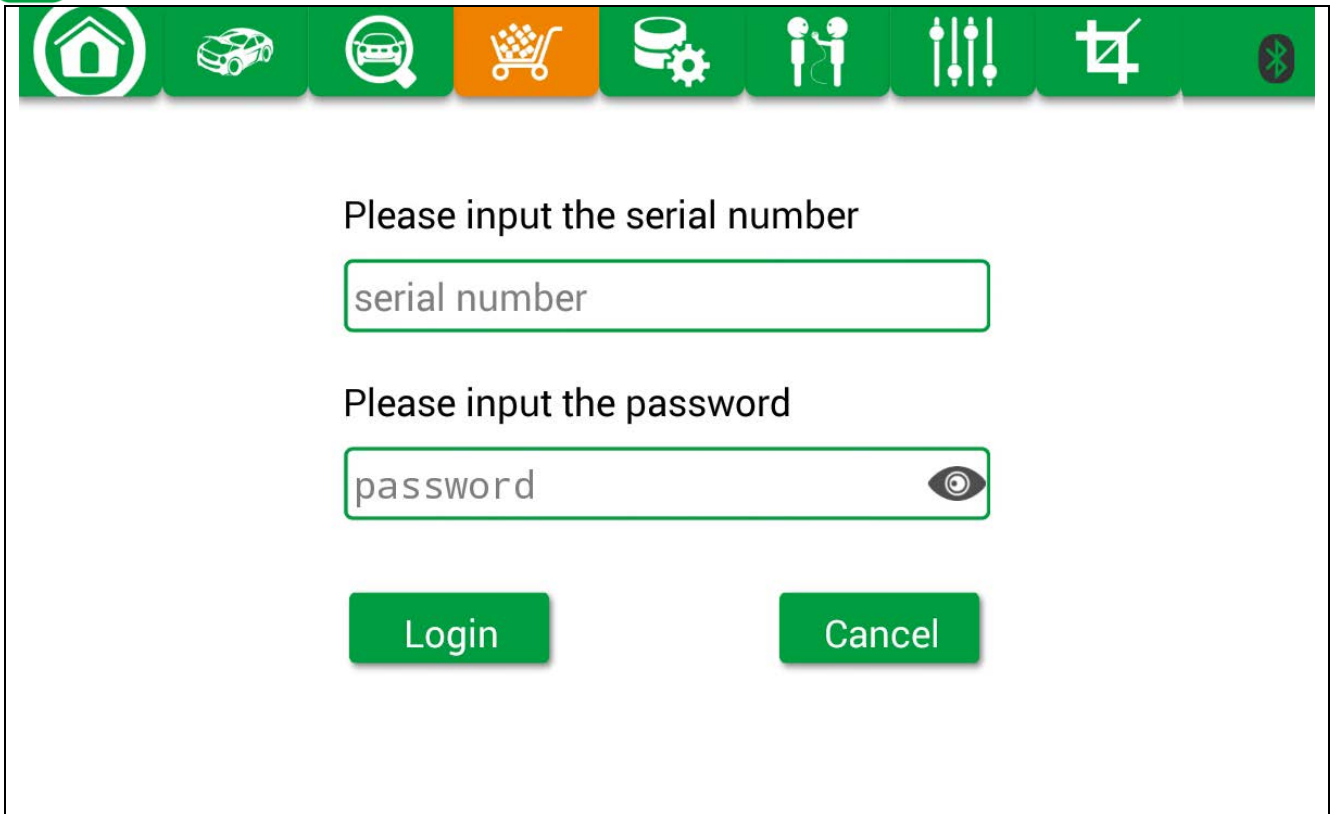

The screenshot shows the XTUNER login screen. At the top is a navigation bar with icons for Home, Car, Search, Shopping Cart, Settings, User, Equalizer, and Bluetooth. Below the navigation bar, the text "Please input the serial number" is displayed above a text input field containing the placeholder "serial number". Below this, the text "Please input the password" is displayed above a password input field containing the placeholder "password" and a toggle icon for visibility. At the bottom, there are two buttons: "Login" and "Cancel".

Please input the S/N number and password getting from the envelope, and then click “Login”.

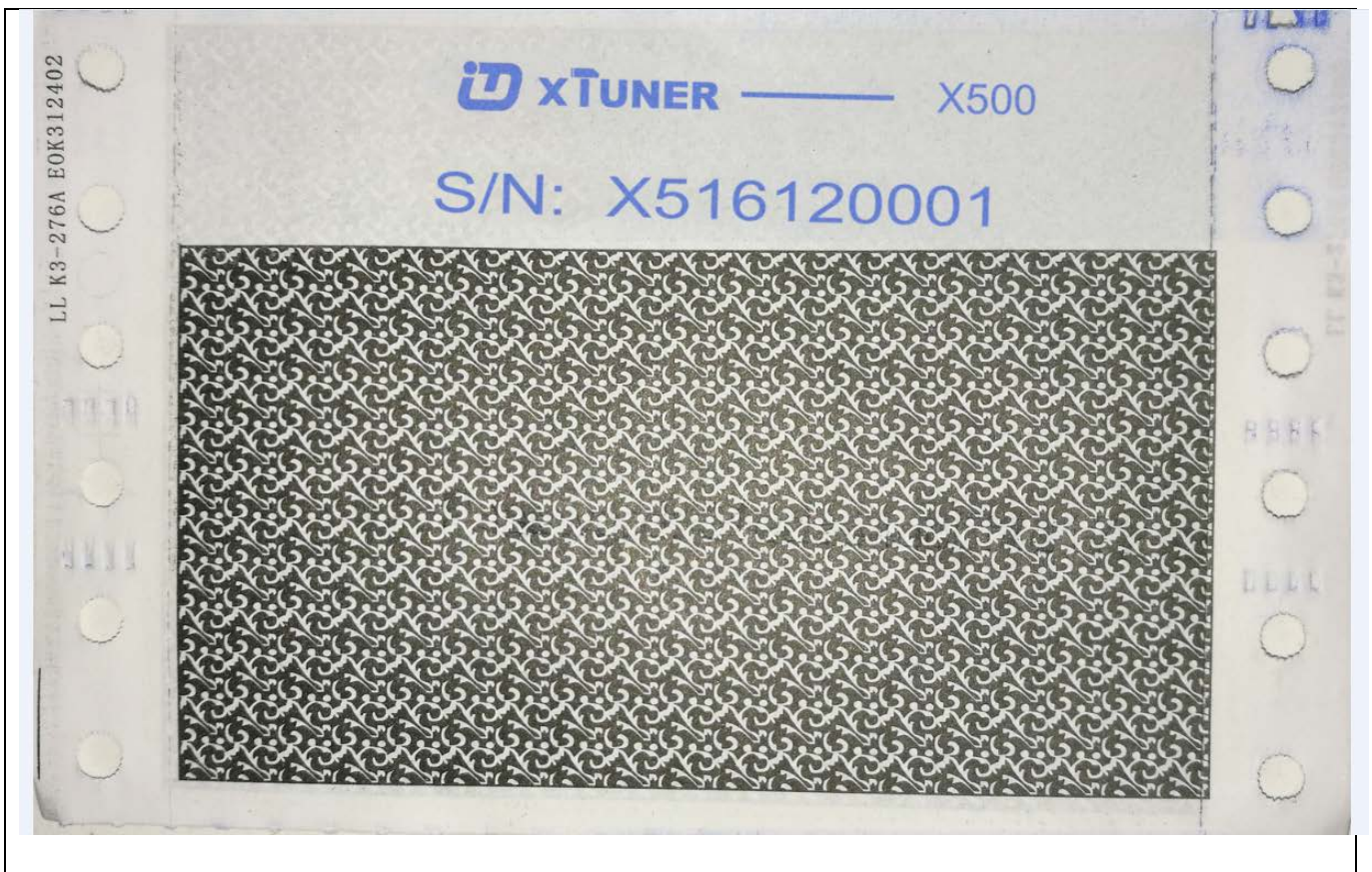

Please input the serial number

Please input the password

Login Cancel

Please click "Login".

Please input the serial number

Please input the password

Please Wait

Login Cancel

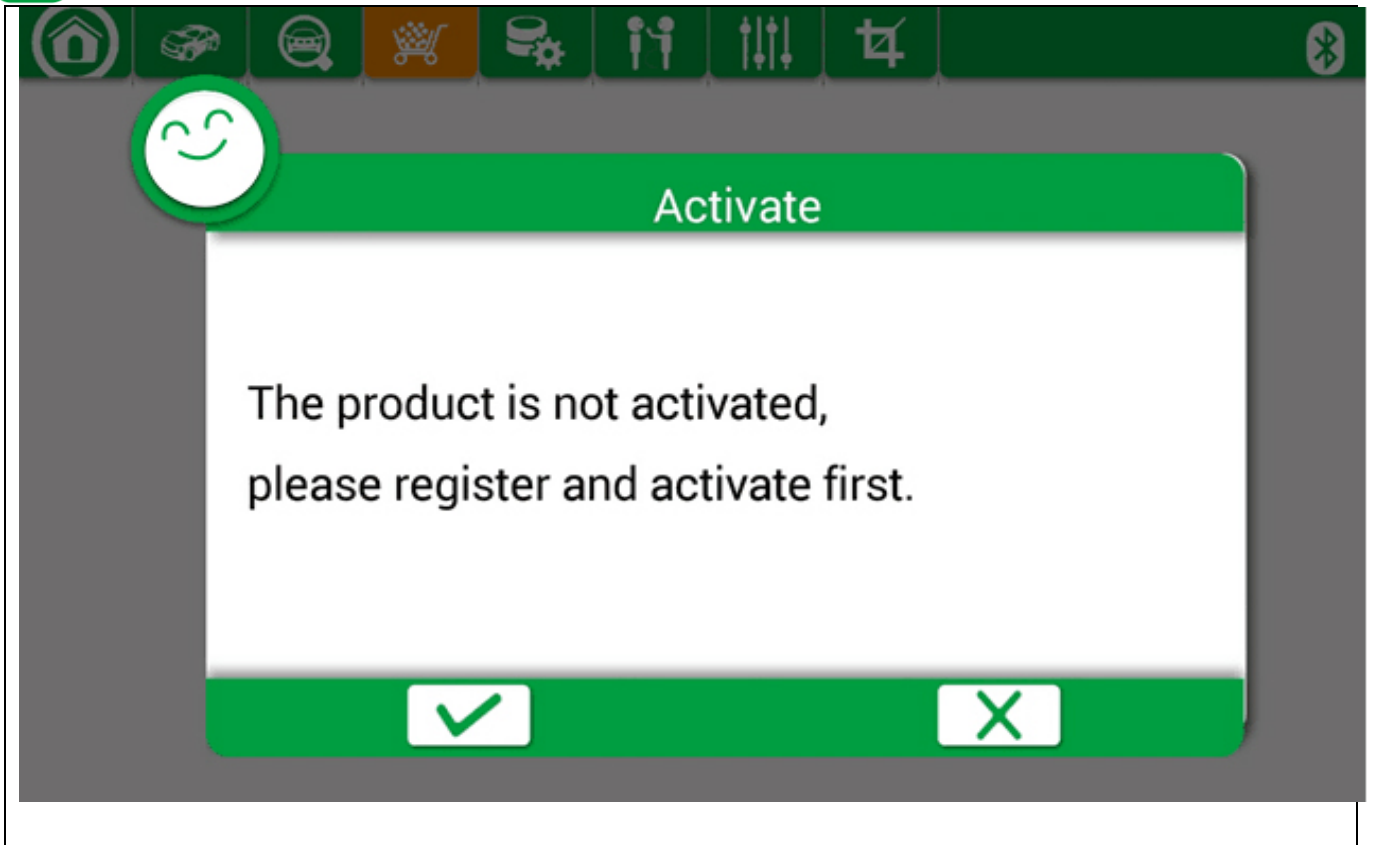

If the product is not activated, please click “Yes”.

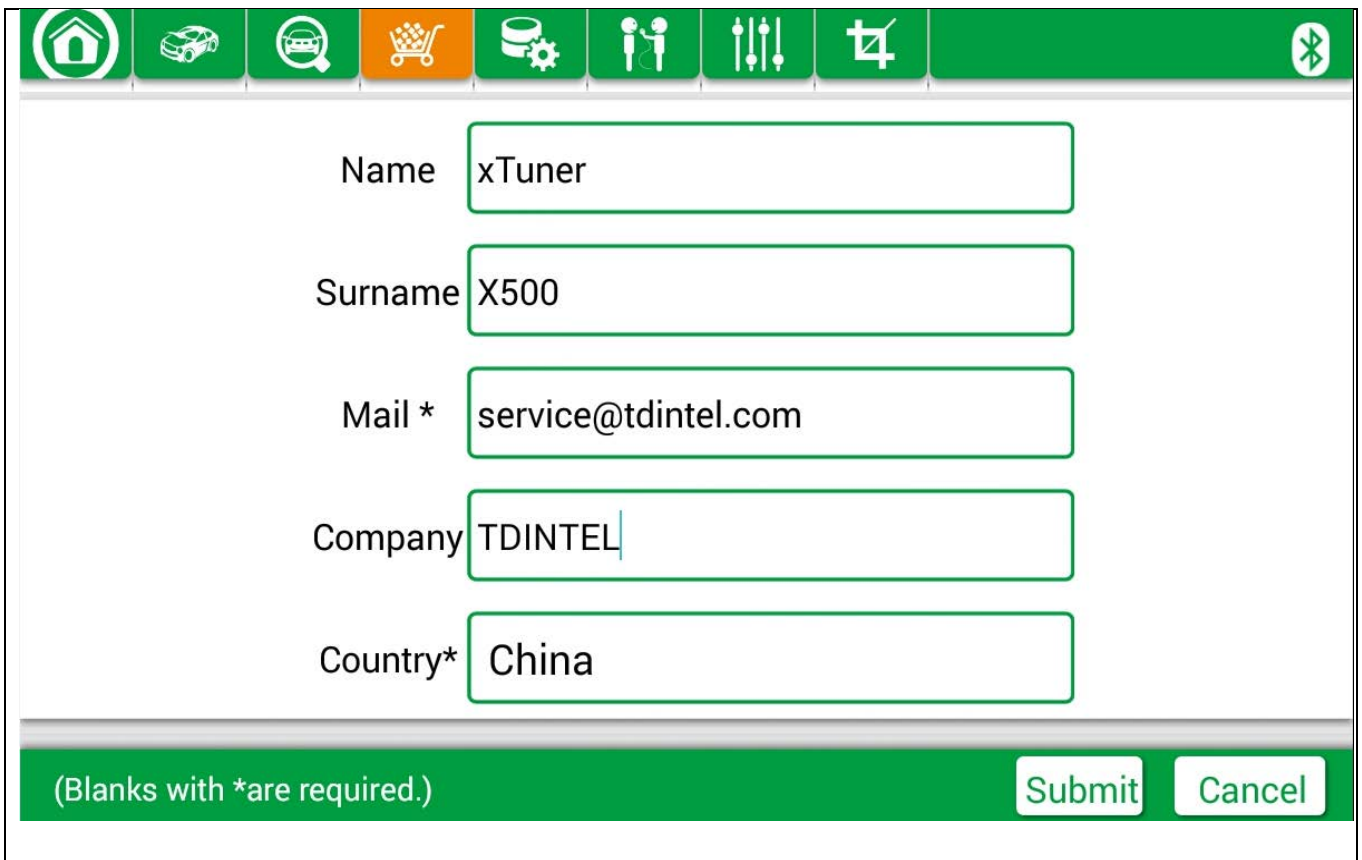

Name	<input type="text" value="xTuner"/>
Surname	<input type="text" value="X500"/>
Mail *	<input type="text" value="service@tdintel.com"/>
Company	<input type="text" value="TDINTEL"/>
Country*	<input type="text" value="China"/>

(Blanks with *are required.)

Please input your information, the Email address and country are required, and then click “Activate”.

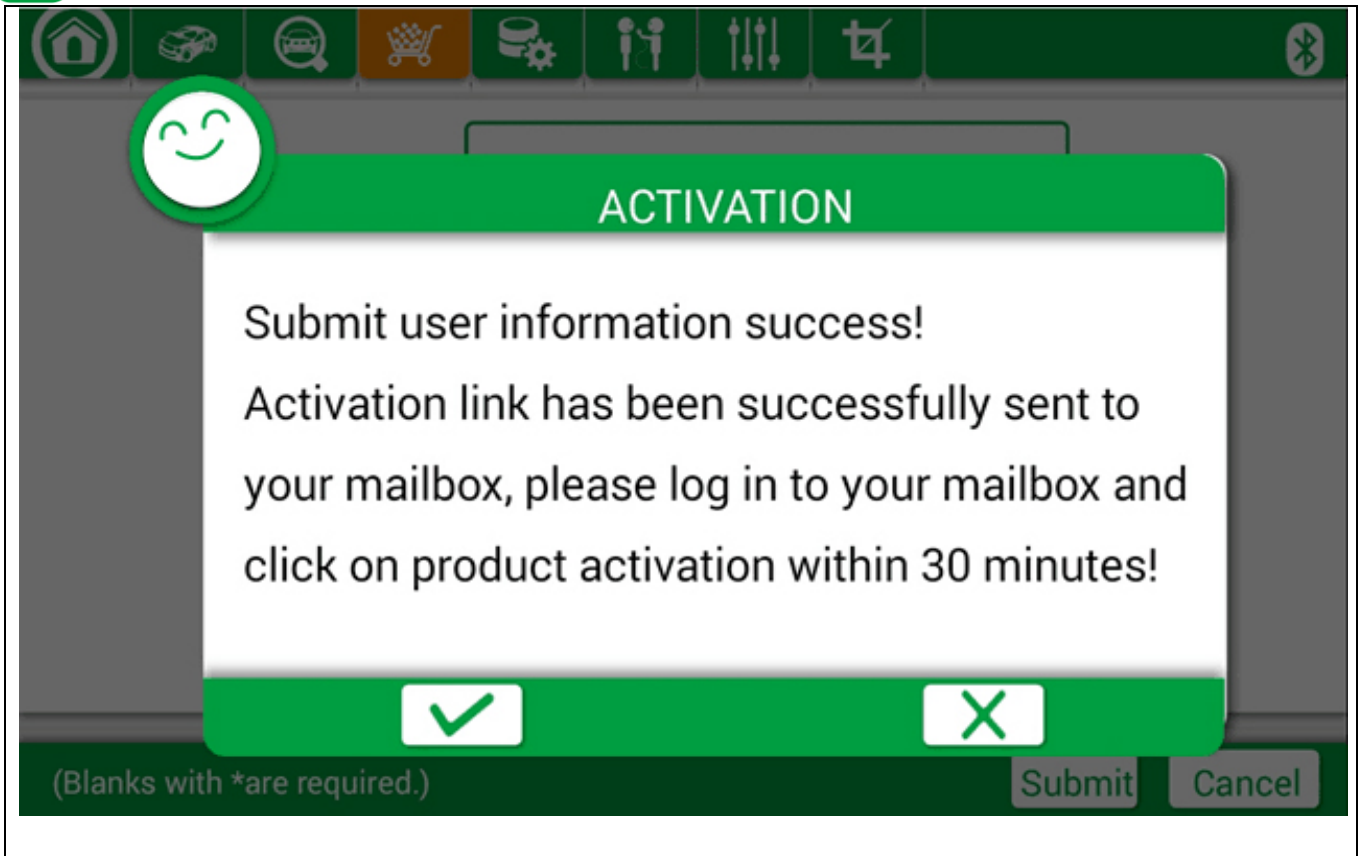

Note:

Your email address must be real in order to get the activation link and the further better service from the manufacturer. The software update reminder and the new product release information will be sent to your mailbox.

If you do not receive the activation email, please add "service@tdintel.com" to the white list of your mailbox and try the activation process again.

Country\Region : please choice your country\region in the list.



Please click the link to get the confirmation from the manufacturer.

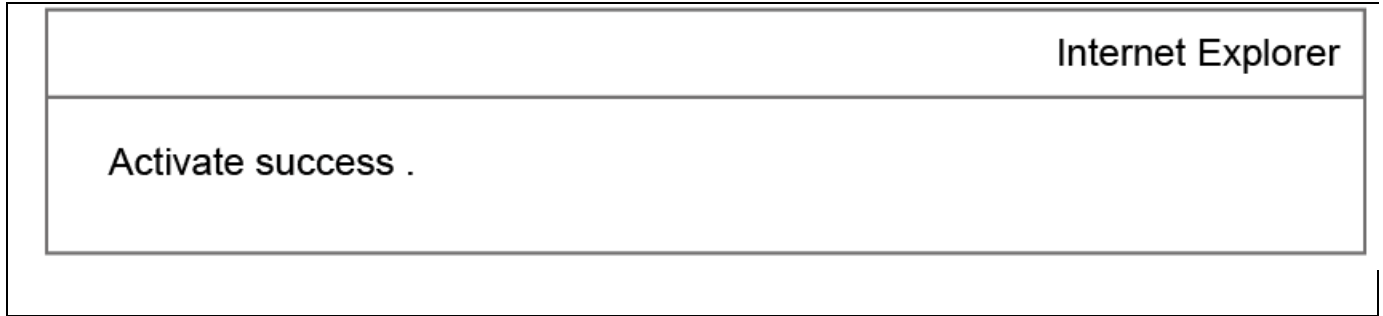

3.2 Software Downloads

After the activation, please login the “APP Store” again, and get the APPs upgrade.

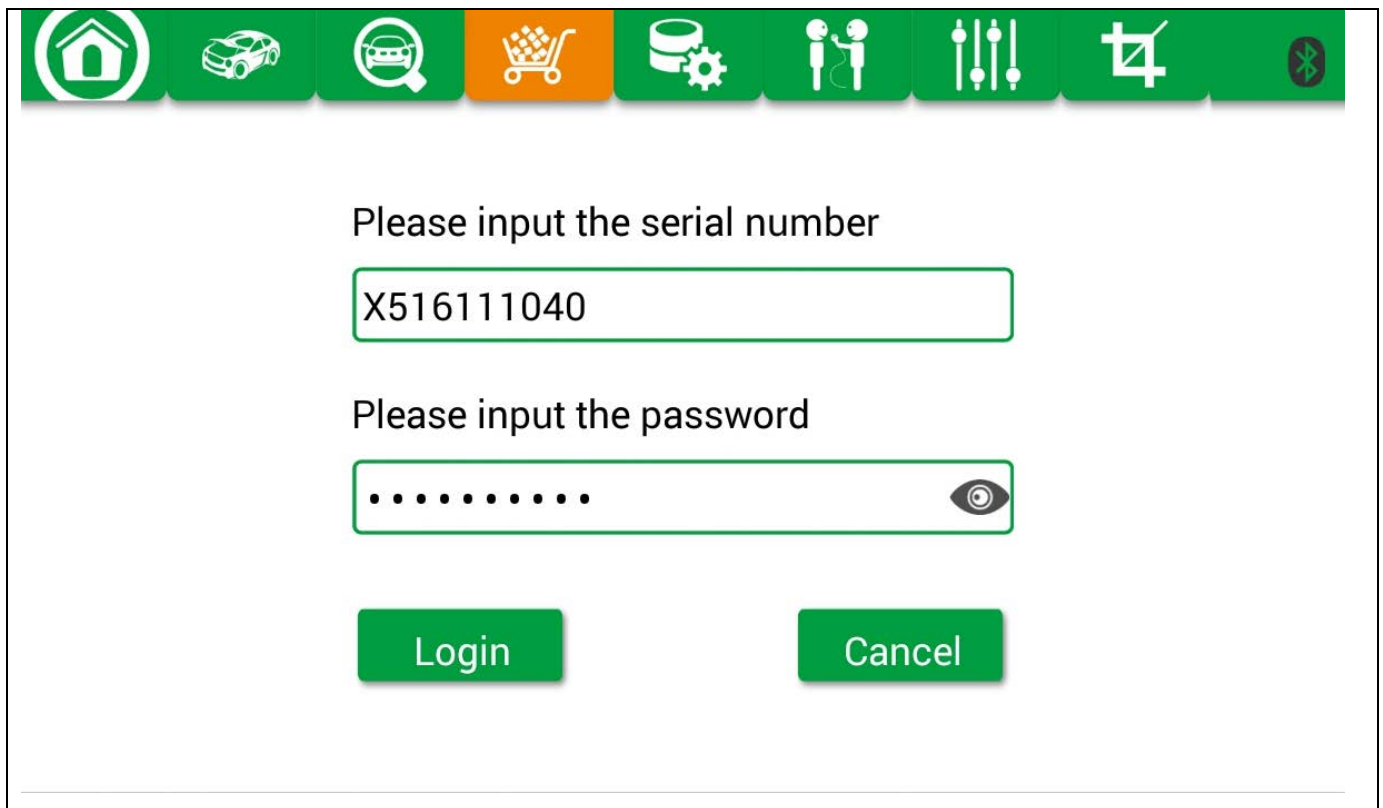

Please, click “Login” to download the software.

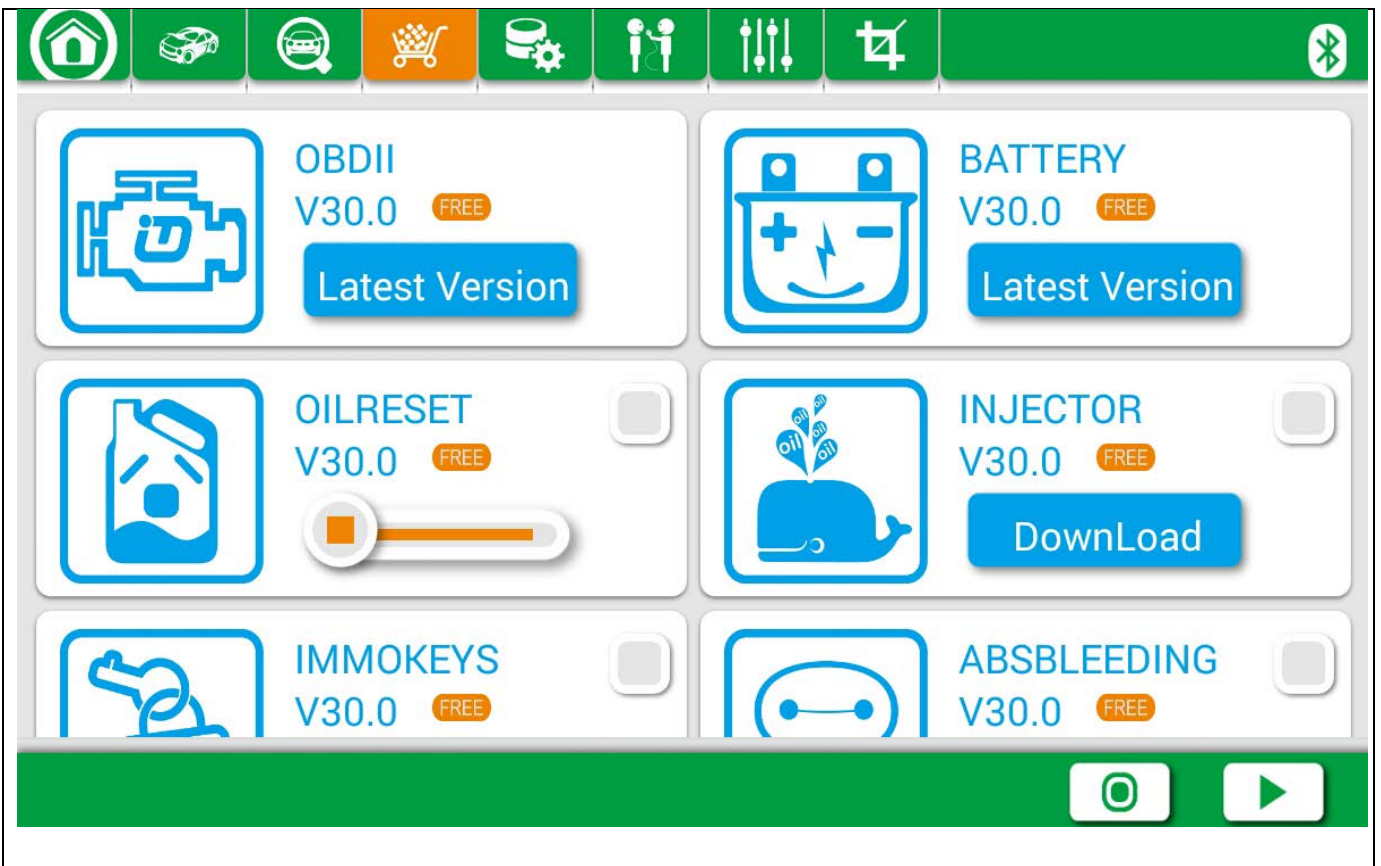
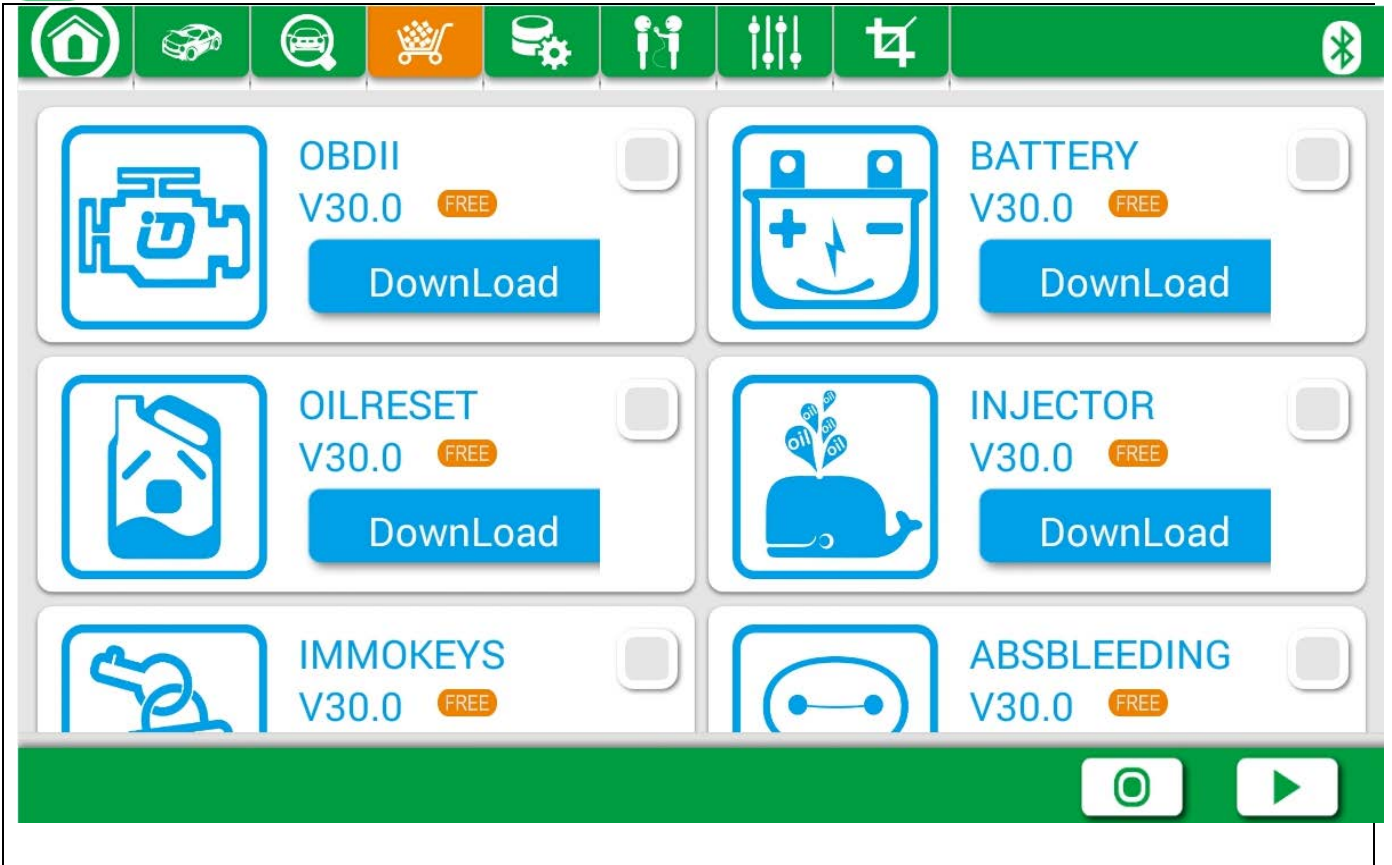

There are two modes for downloading, one by one and one-click. It may take a long time to download all the software, due to customers' network speed reason.

3.2 Software Management

Users can delete vehicle software here. You can delete one by one or all-selected delete.

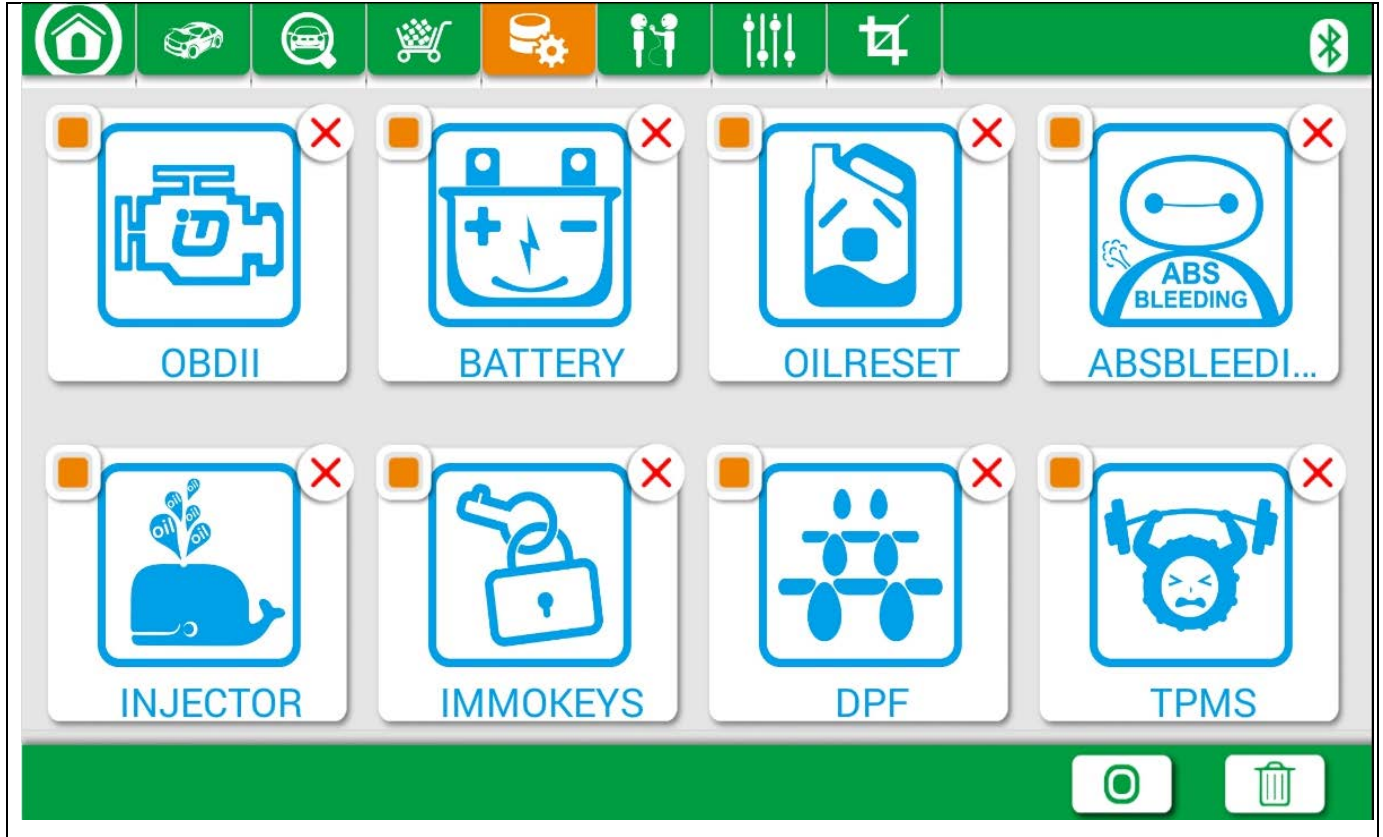

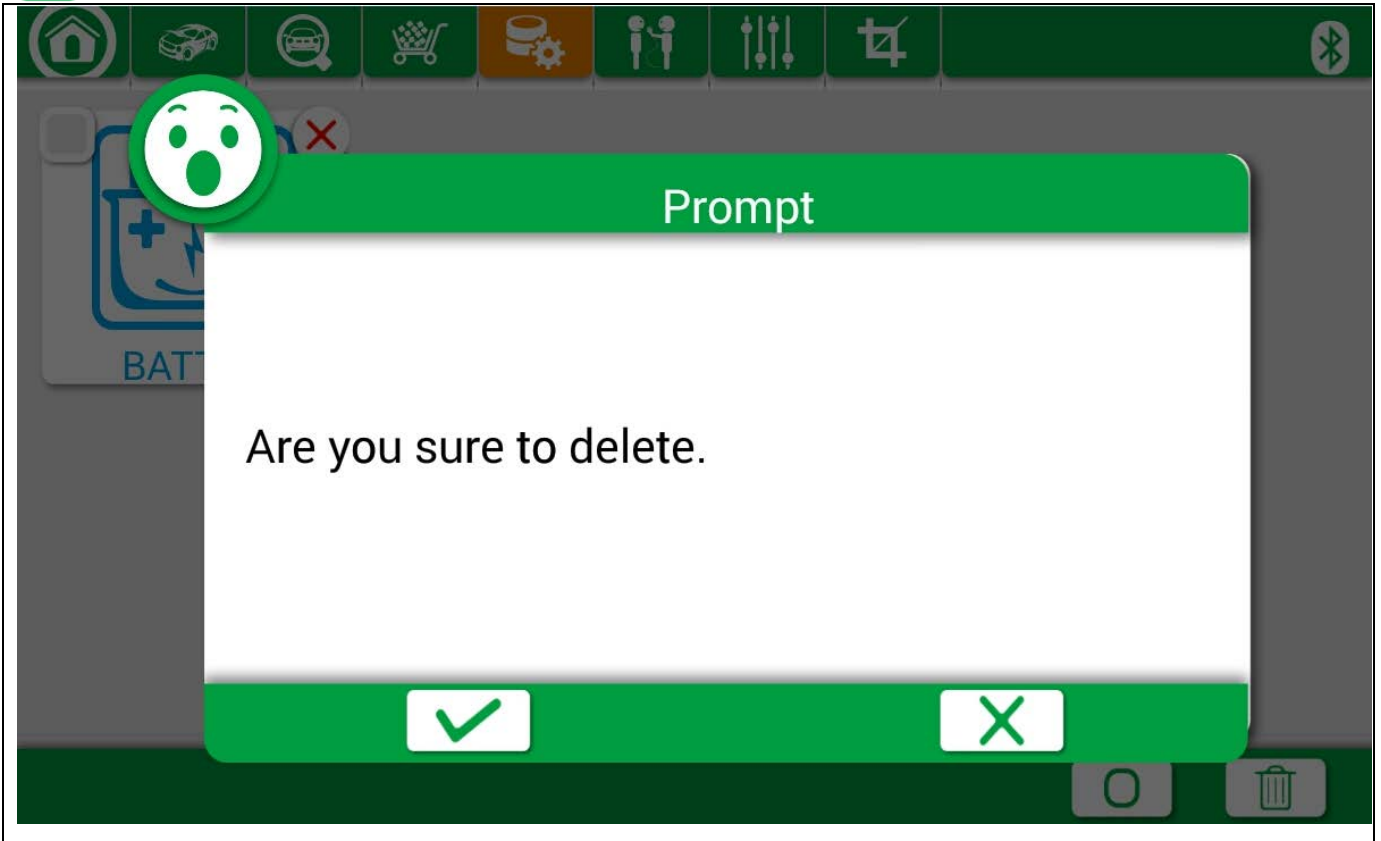

4. Software Introduction

Run X500, the screen will show:

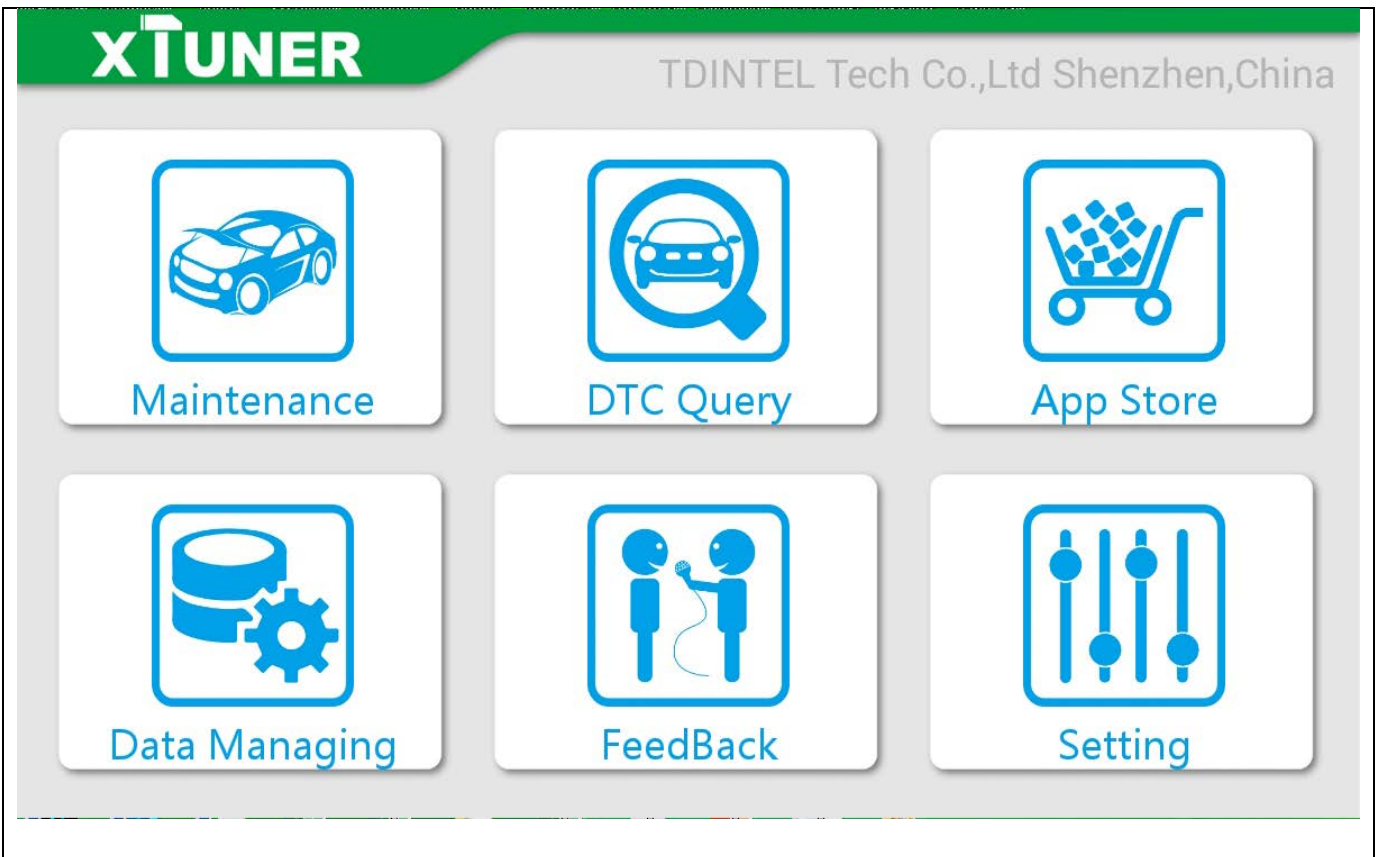

4.1 APP Store

Features:

Automatic Wi-Fi updates are available in new software releases by smart upgrade mode.

Wi-Fi internet capability allows for wireless access throughout the workshop.

Extremely easy-to-use with touch-screen operation and intuitive operation in the Android.

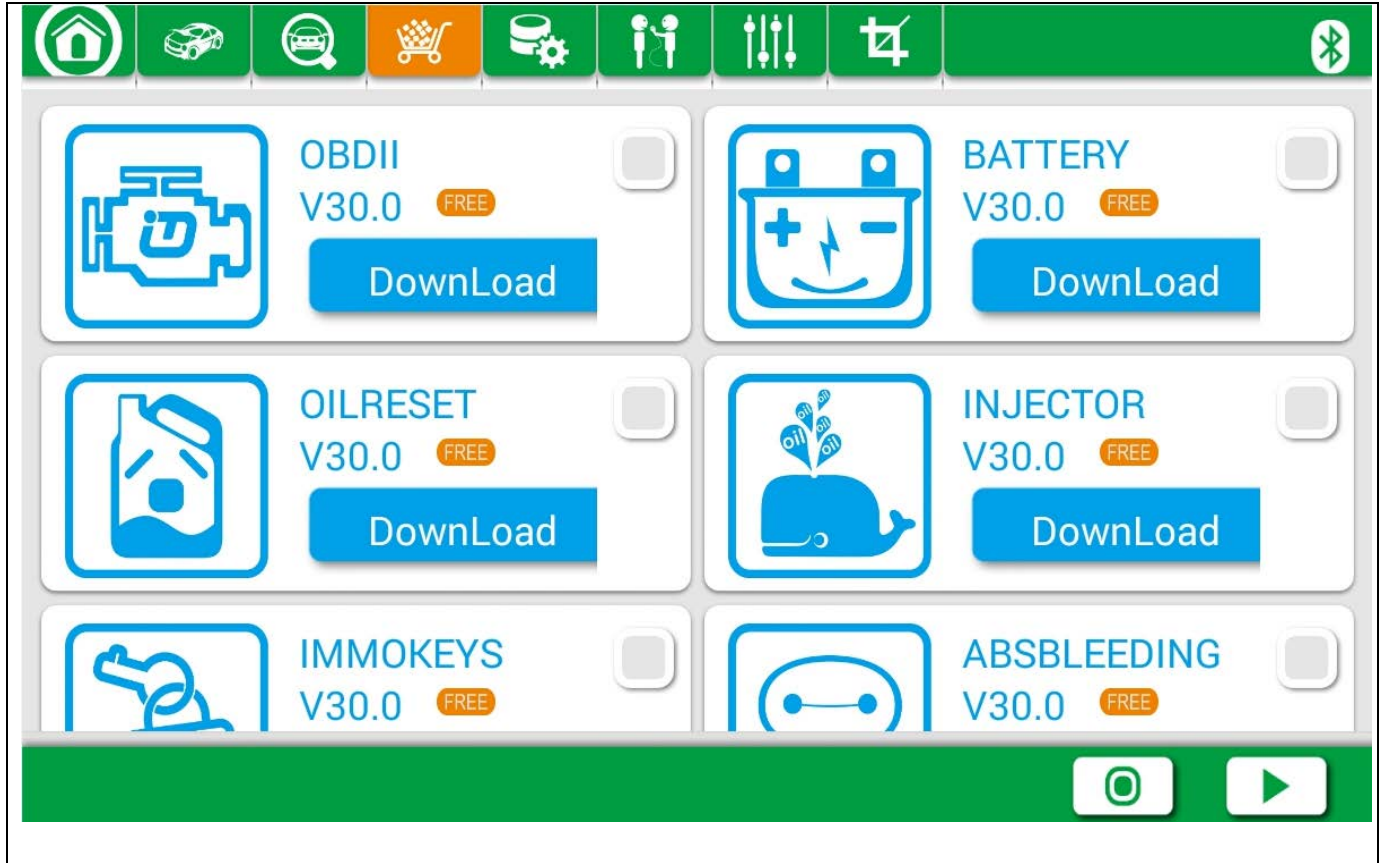

4.2 Maintenance Service

OBDII vehicle: CHRYSLER, FORD, GM, TOYOTA, LEXUS, HONDA, HYUNDAI, KIA, MAZDA, MITSUBISHI, NISSAN, SUBARU, SUZUKI, ABARTH, ASTON MARTIN, BUGATTI, FERRARI, LAMBORGHINI, MASERTI, BENZ, BMW, VW, AUDI, SEAT, SKODA, PORSCHE, JAGUAR, LANDROVER, VOLVO, SAAB, ALFA, etc.

ABS BLEEDING RESET: CITROEN, DAEWOO, JAGUAR, LANDROVER, OPEL, PEUGEOT, RENAULT, SSANGYONG, etc.

BATTERY RESET: FORD, JAGUAR, LANDROVER, LEXUS, TOYOTA, VOLVO, etc.



DPF RESET: CITROEN, DAEWOO, JAGUAR, LANDROVER, OPEL, PEUGEOT, SUBARU, VAUXHALL, etc.

EPB RESET: BENZ, BMW, CITREON, DAEWOO, HONDA, JAGUAR, LANDROVER, OPEL, PEUGEOT, RENAULT, SAAB, SUBARU, TOYOTA, VAUXHALL, VOLVO, VW, BUICK, CADILLAC, CHEVROLET, CADILLAC, CHEVROLET TRUCK, etc.

OIL RESET: ACURA, AUDI, BENZ, BESTURN, BENTLEY, BUGATTI, BMW, CHRYSLER, CITROEN, DACIA, DAEWOO, DODGE, FERRARI, FORD, HOLDEN, HONDA, HYUNDAI, INFINITI, ISUZU, JAGUAR, JEEP, KIA, LANDROVER, LAMBORGHINI, LEXUS, LINCOLN, MASERATI, MINI, MITSUBISHI, NISSAN, OLDSMOBILE, OPEL, PEUGEOT, PORSCHE, PONTIAC, RENAULT, ROLLS-ROYCE, ROMEO, ROVER, SAAB, SATURN, SCION, SEAT, SKODA, SMART, SUBARU, SUZUKI, TOYOTA, VAUXHALL, VOLVO, VW, BUICK, CADILLAC, CHEVROLET, GMC, HUMMER, BAIC, BYD, CHERY, FAW CAR, GREATWALL, JAC, LUXGEN, SOUEAST, ROVER, etc.

TPMS RESET: CITROEN, FORD, HONDA, KIA, MITSUBISHI, NISSAN, PEUGEOT, RENAULT, TOYOTA, BENZ, CHRYSLER, HYUNDAI, MAZDA, ACURA, BUICK, CADILLAC, CHEVROLET, DODGE, GMC, HUMMER, INFINITI, LINCOLN, JEEP, LEXUS, PONTIAC, SATURN, SCION, GM, AUDI, BMW, JAGUAR, PORSCHE, SUBARU, VW, LANDROVER, SGM, etc.

IMMO&KEYS RESET: DODGE, JEEP, ACURA, ALFA, BENZ, BWM, CITREON, FIAT, FORD, HONDA, JAGUAR, LANDROVER, LEXUS, MAZIDA, MITSUBISHI, OPEL, PEUGEOT , PROTON, SUBARU, ISUZU, SMART, SCION, SSANGYONG, TOYOTA, VW, BUICK, CHEVROLET, CADILLAC, GMC, HUMMER, NISSAN, KIA, INFINITI, ZOTYE, EMGRAND, ENGLONCAR, GEELY, DFCITREON, DFNISSAN, DFPEUGEOT, QYMAZIDA, YUEDA, HYUNDAI, etc.

INJECTOR RESET: CITROEN, FAIT, JAGUAR, KIA, LANDROVER, MITSUBISHI, OPEL, SUBARU, VAUXHALL, TOYOTA, SCION, HYUNDAI, etc.

4.3 Setting

4.3.1 Run Mode

It has Demo, so even X500 is not connected, it can simulate how X500 works. As the picture shows:

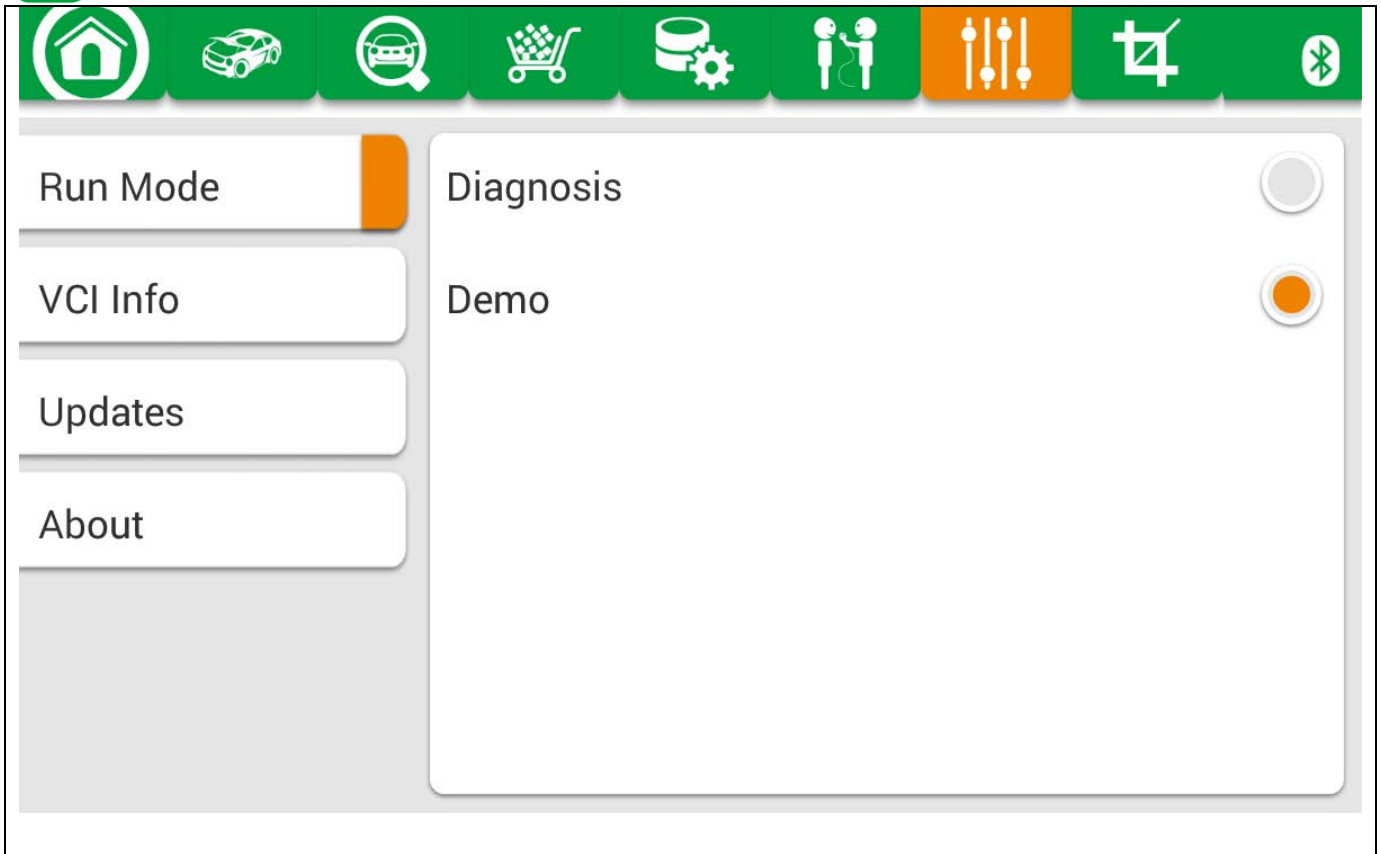

4.3.2 VCI Info

Here can read X500 VCI version information after the VCI connected. If the connection has problem (Bluetooth), and it can't read X500 Hardware version, it shows as "Unknown" usually.

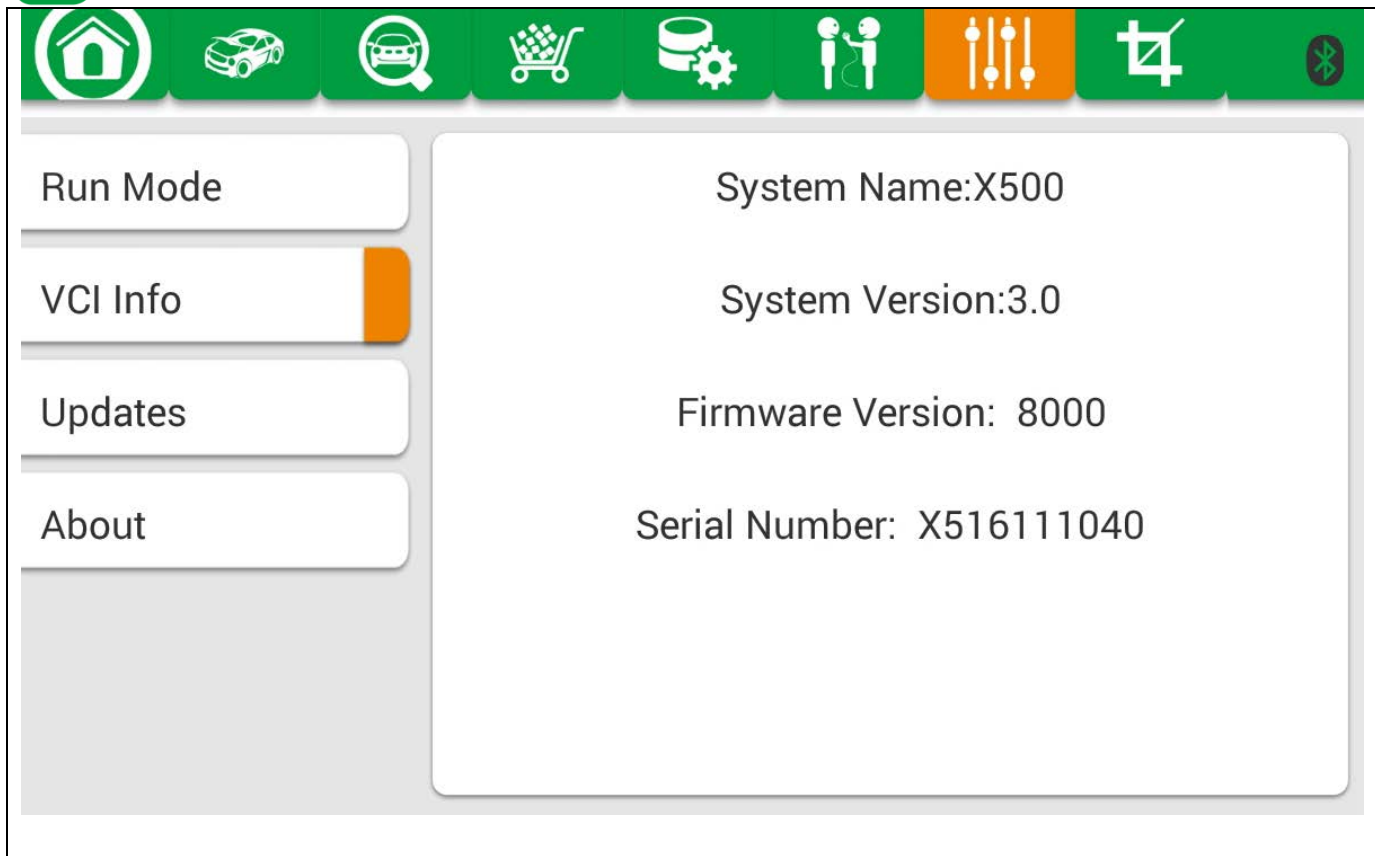

4.3.3 Updates

If there is a new version, it can automatically prompt to update.

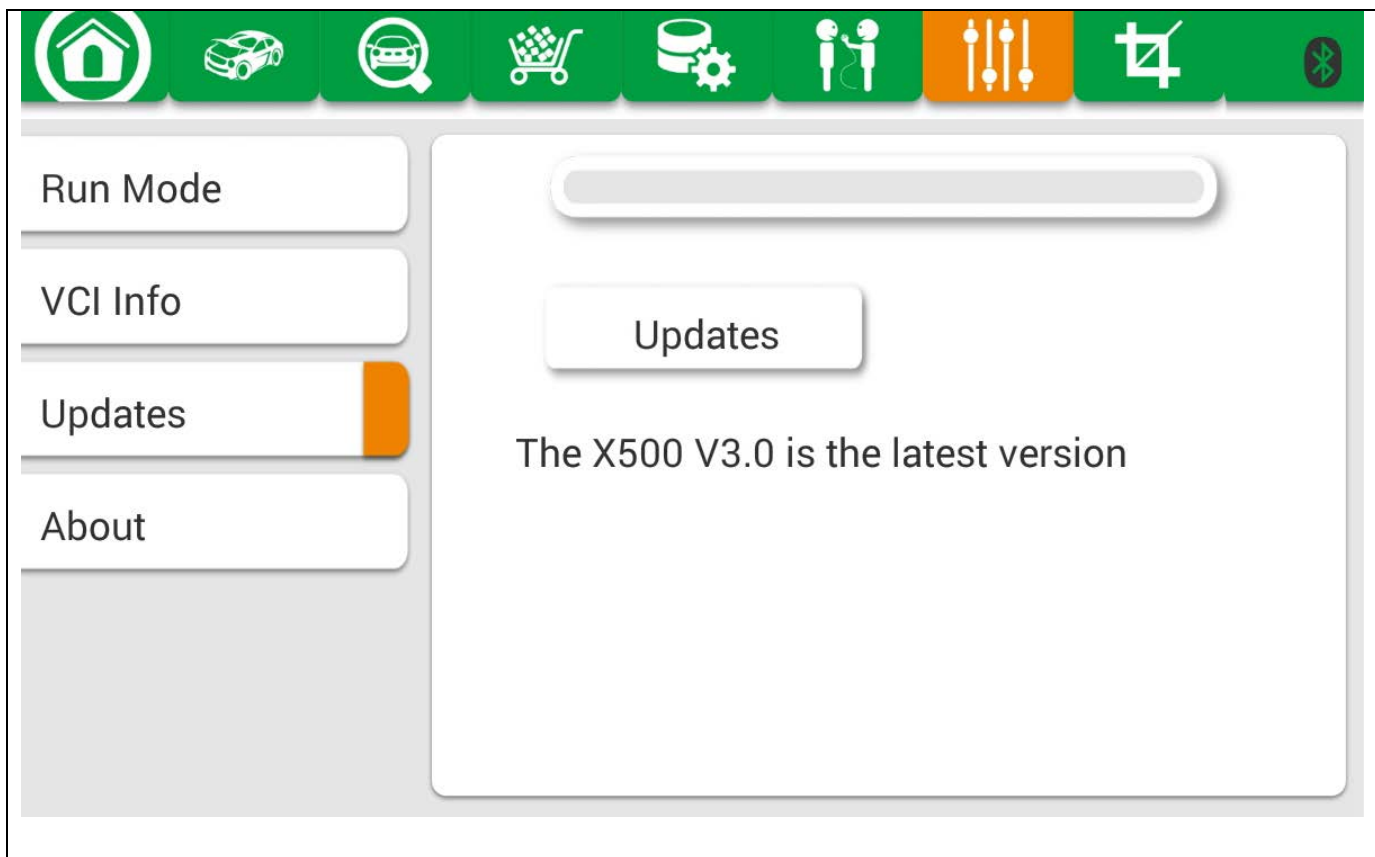

4.3.4 About

Company profile: company's development philosophy, talents objective etc.

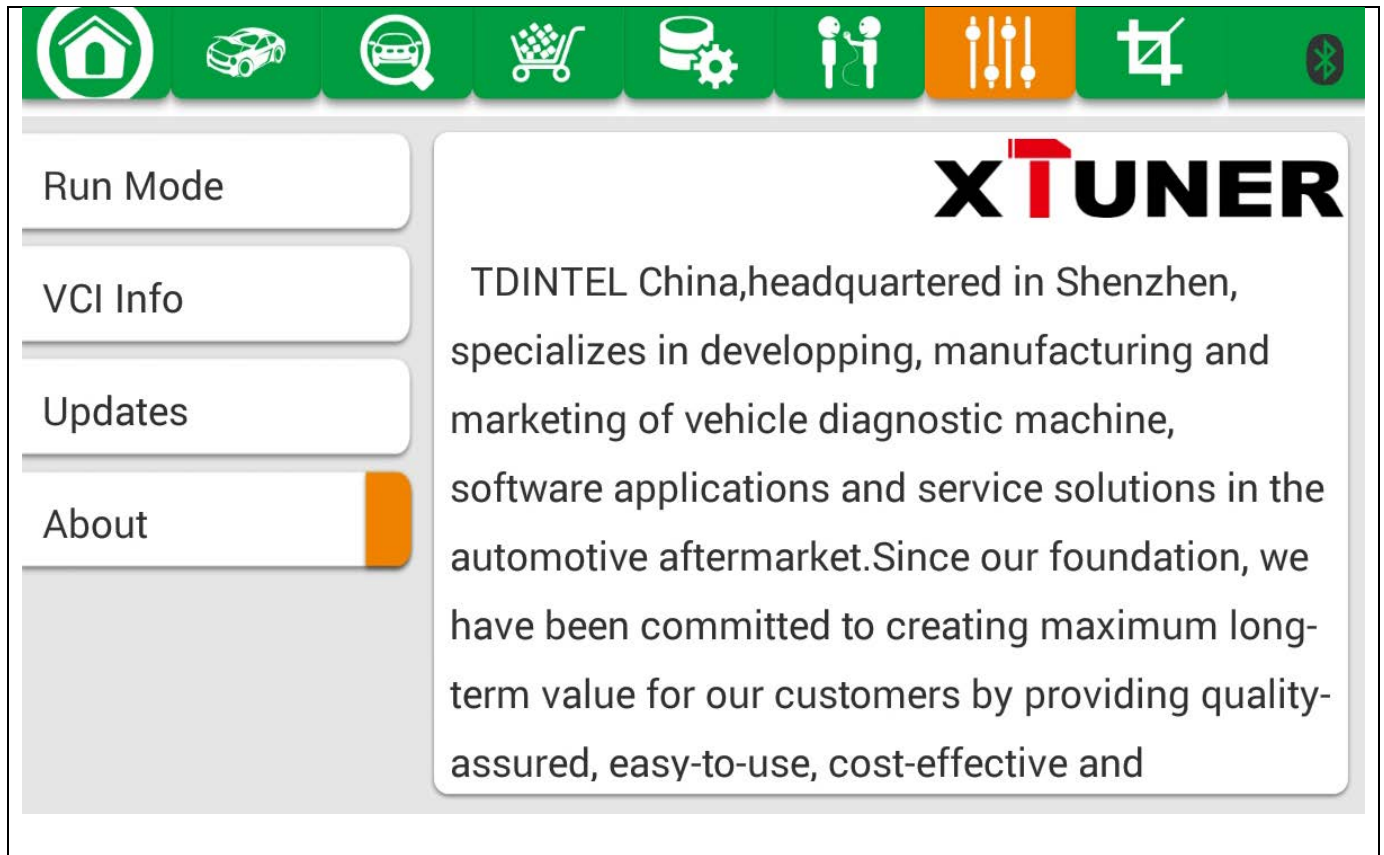

4.4 DTC Query

DTC query function is a DIY function, users can query, modify and create OBD DTCs by their own requirement in local DTCs, and users can synchronize to TDINTEL company cloud server through the internet too.

Systems : P=Powertrain C=Chassis B=Body U=Network

Code Type Generic(SAE): P0,P2,P34-39,B0,B3,C0,C3,U0,U3
 Manufacturer Specific: P1,P30-P33,B1,B2,C1,C2,U1,U2

Sub-systems: 1=Fuel and Air Metering 2=Fuel and Air Metering
 3=Ignition System or Engine Misfire 4=Auxiliary Emission Controls
 5=Vehicle Speed Control & Idle Controls 6=Computer Output Circuits
 7=Transmission Controls 8=Transmission Controls

Identifying specific malfunctioning section of the systems

Search results for 'p1111':

- ID:P1111
Vehicle:GM_HOLDEN
Description:Intake air temperature sensor signal high
- ID:P1111
Vehicle:FORD
Description:Code unallocated

4.5 Example

4.5.1 Communication

Please connect X500 with the car. The indication light turns on red when it power on.

Please check the connection of Bluetooth, if connect successfully, the indication light will turn to blue.

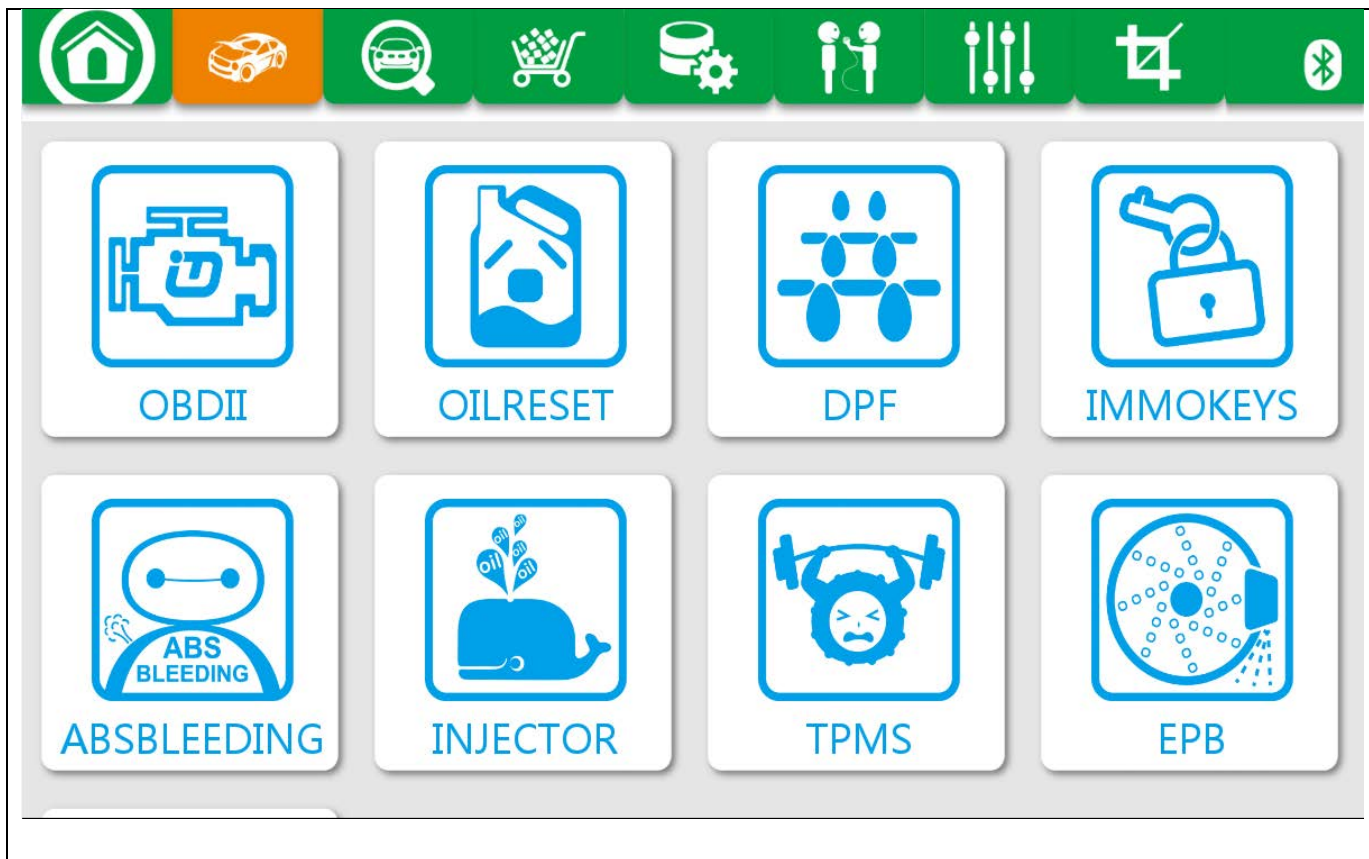

Run the X500, and start to diagnose.

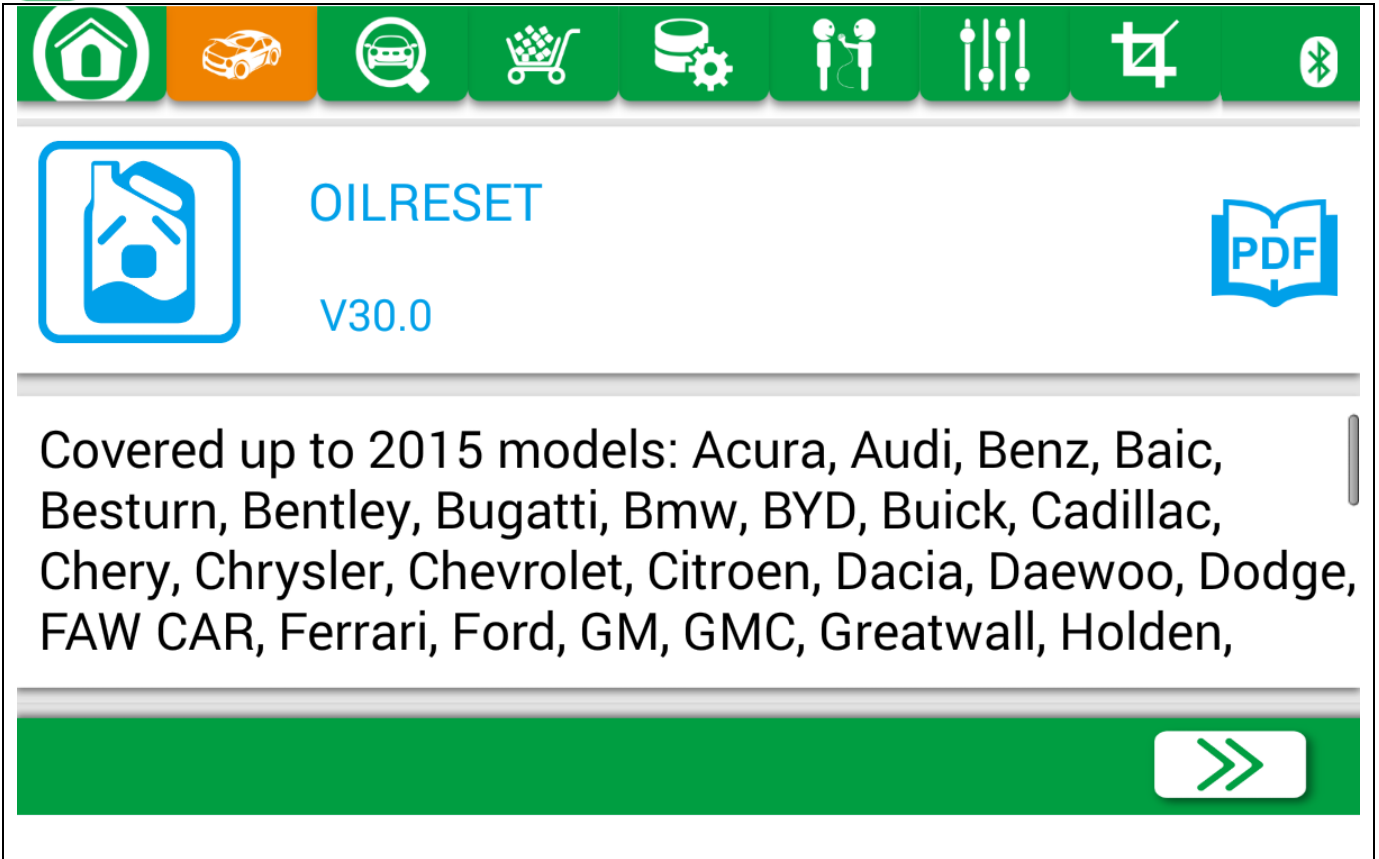

Choose the vehicle you need, and into the diagnostic system:

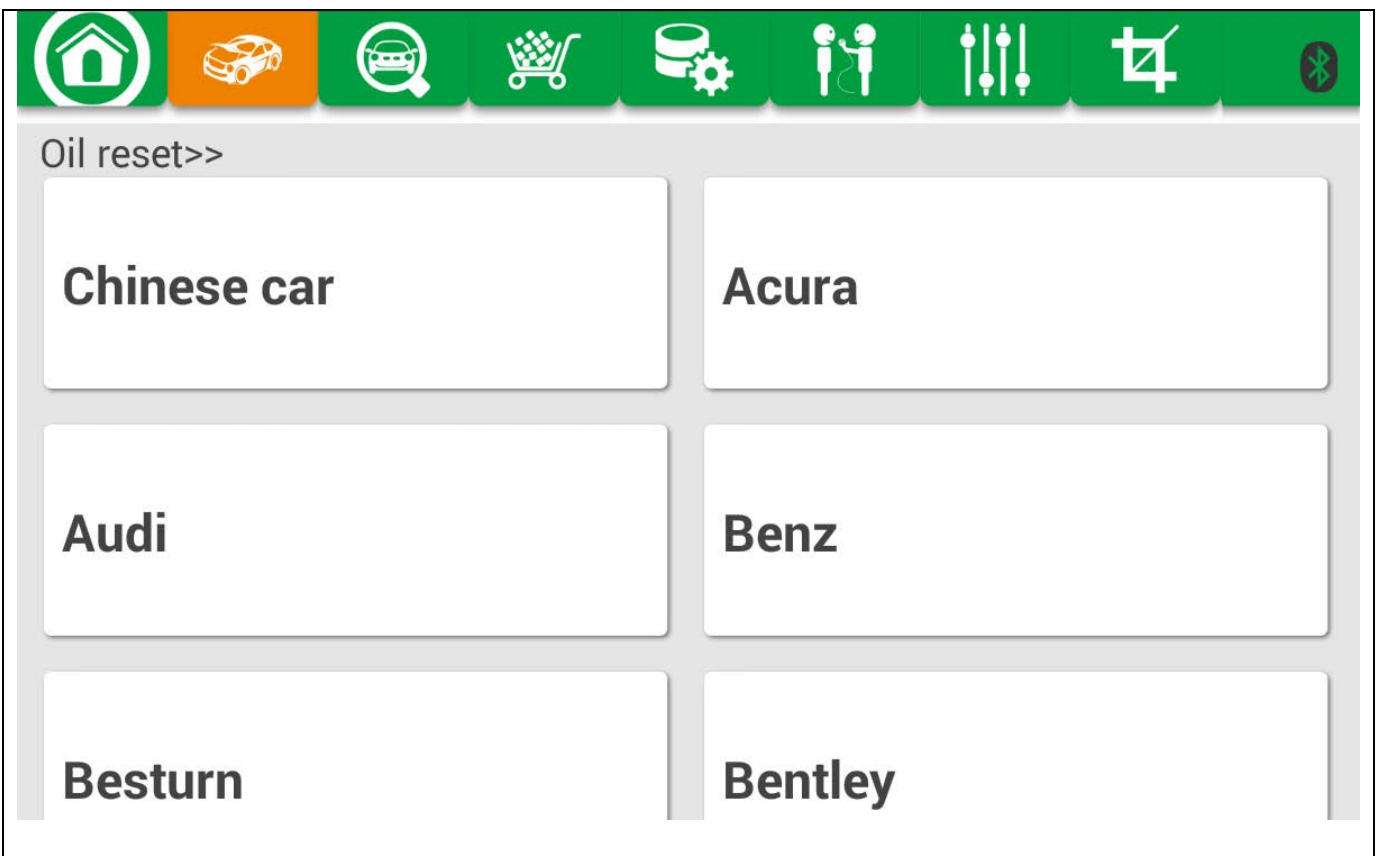

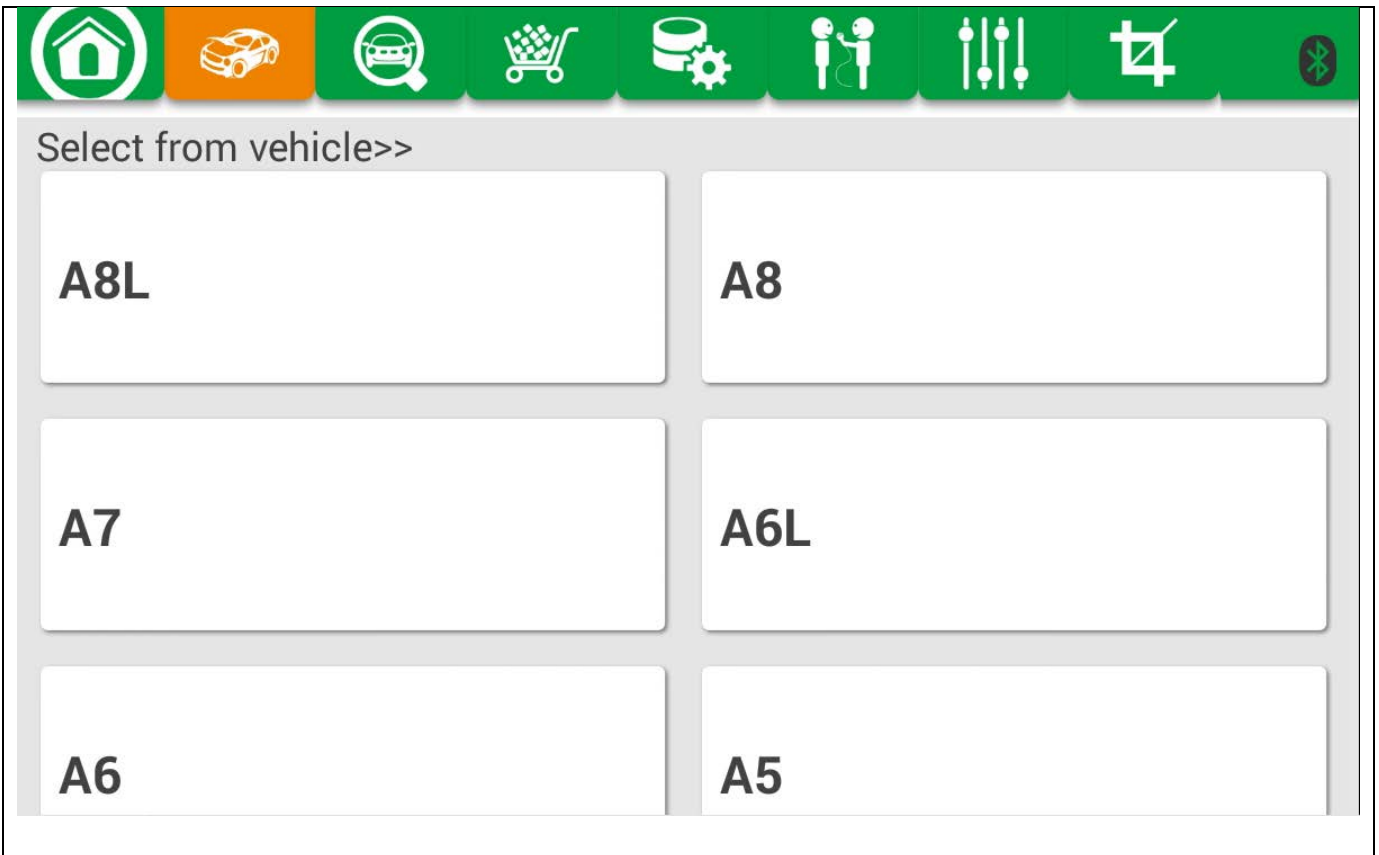
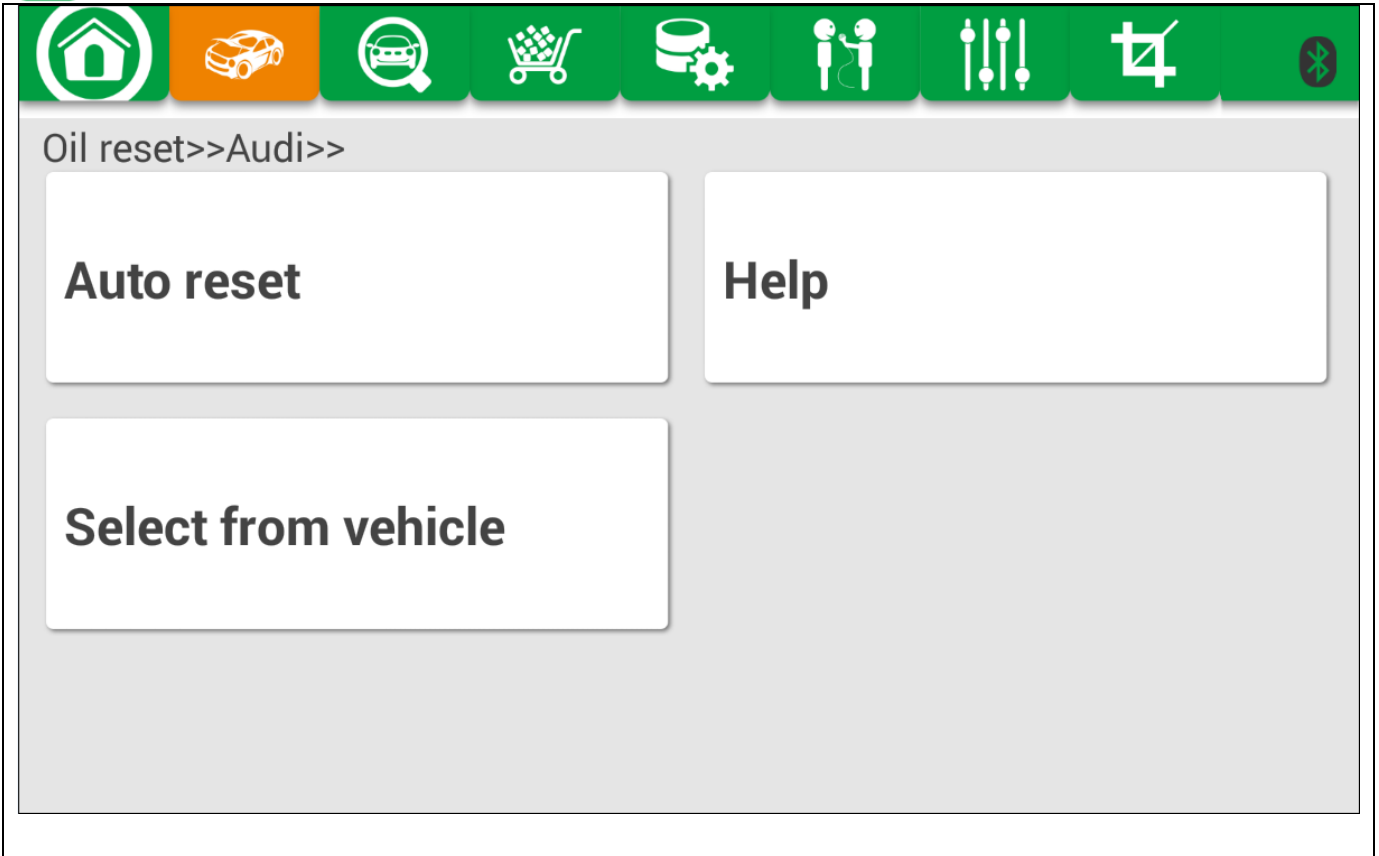

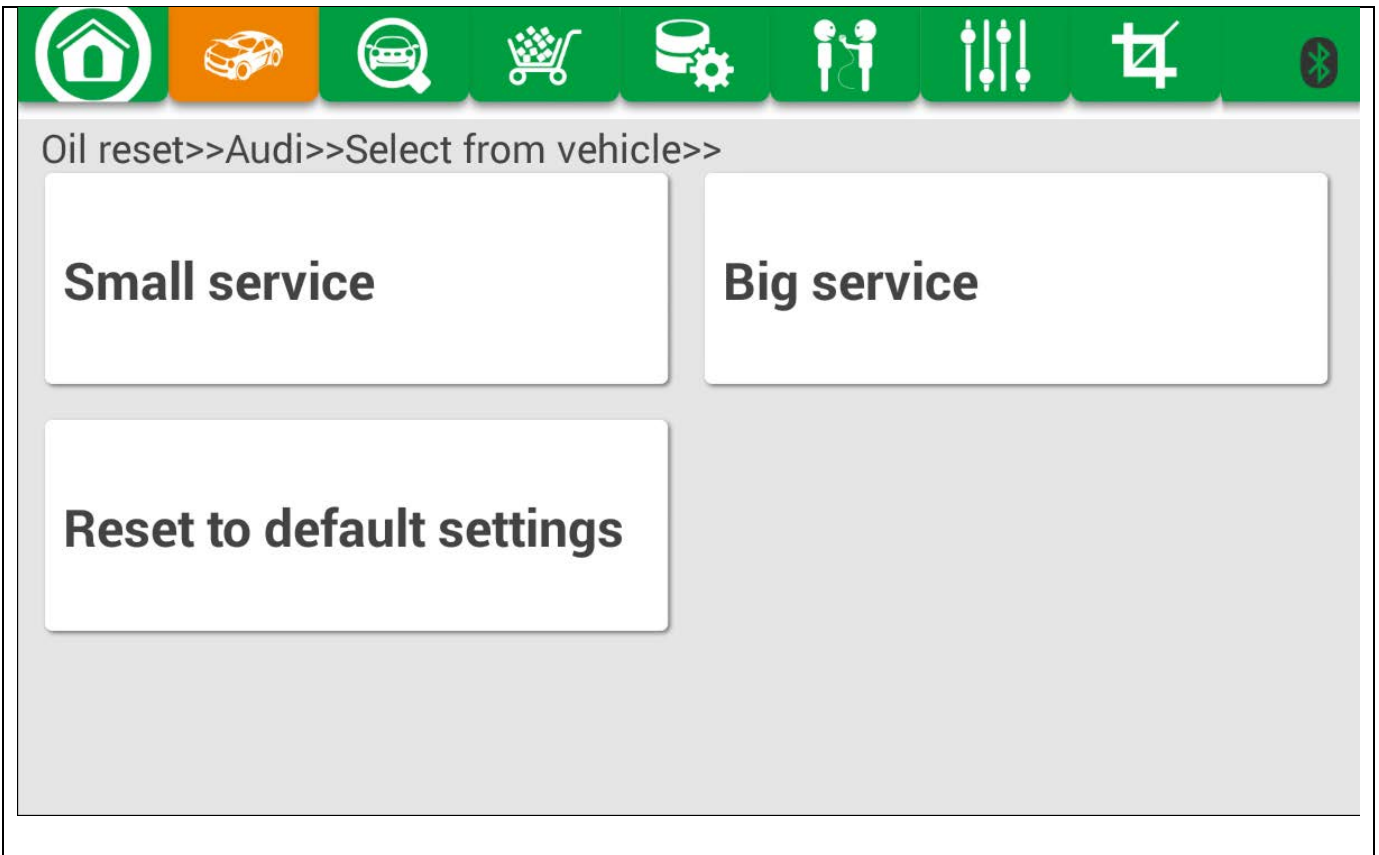
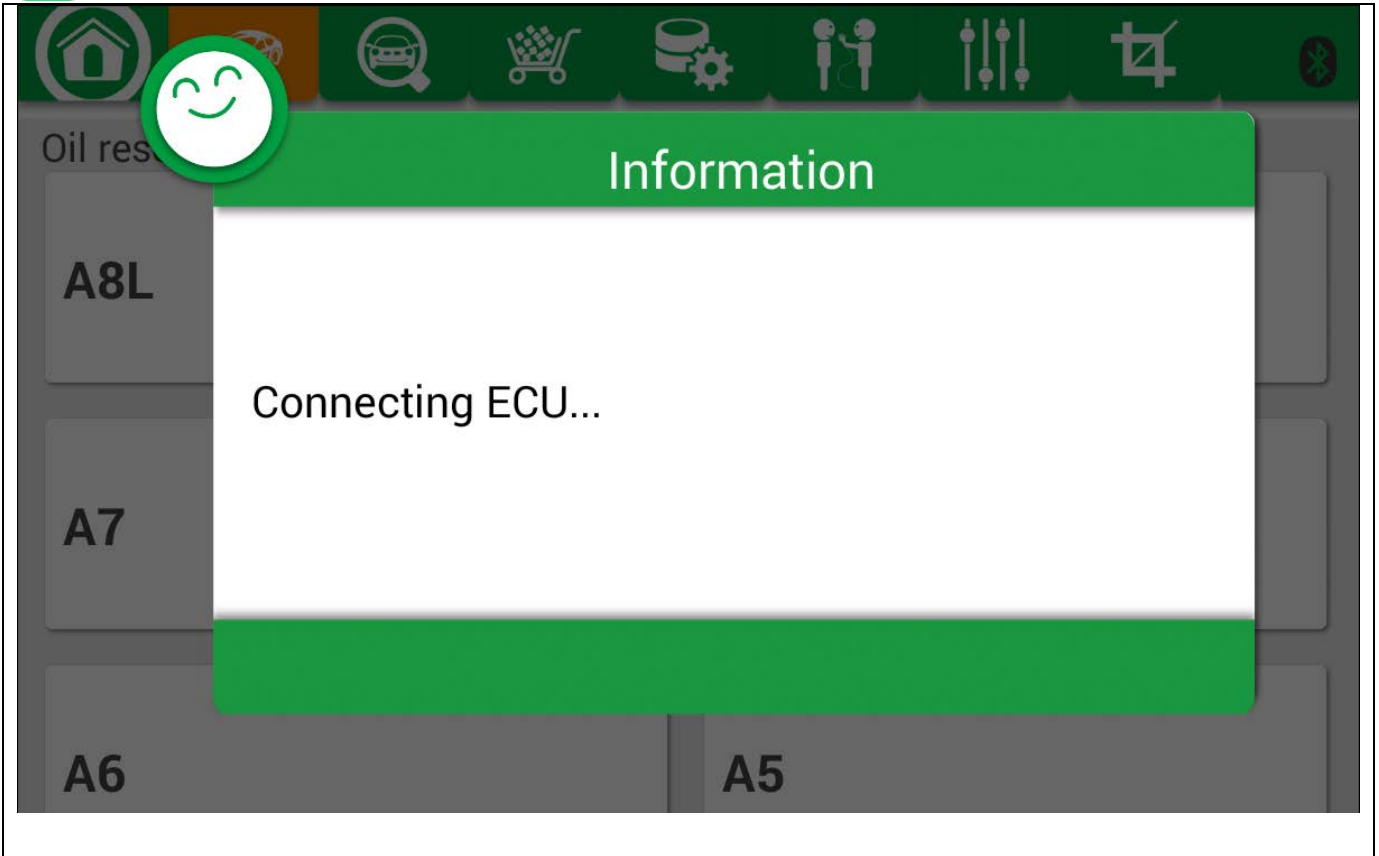

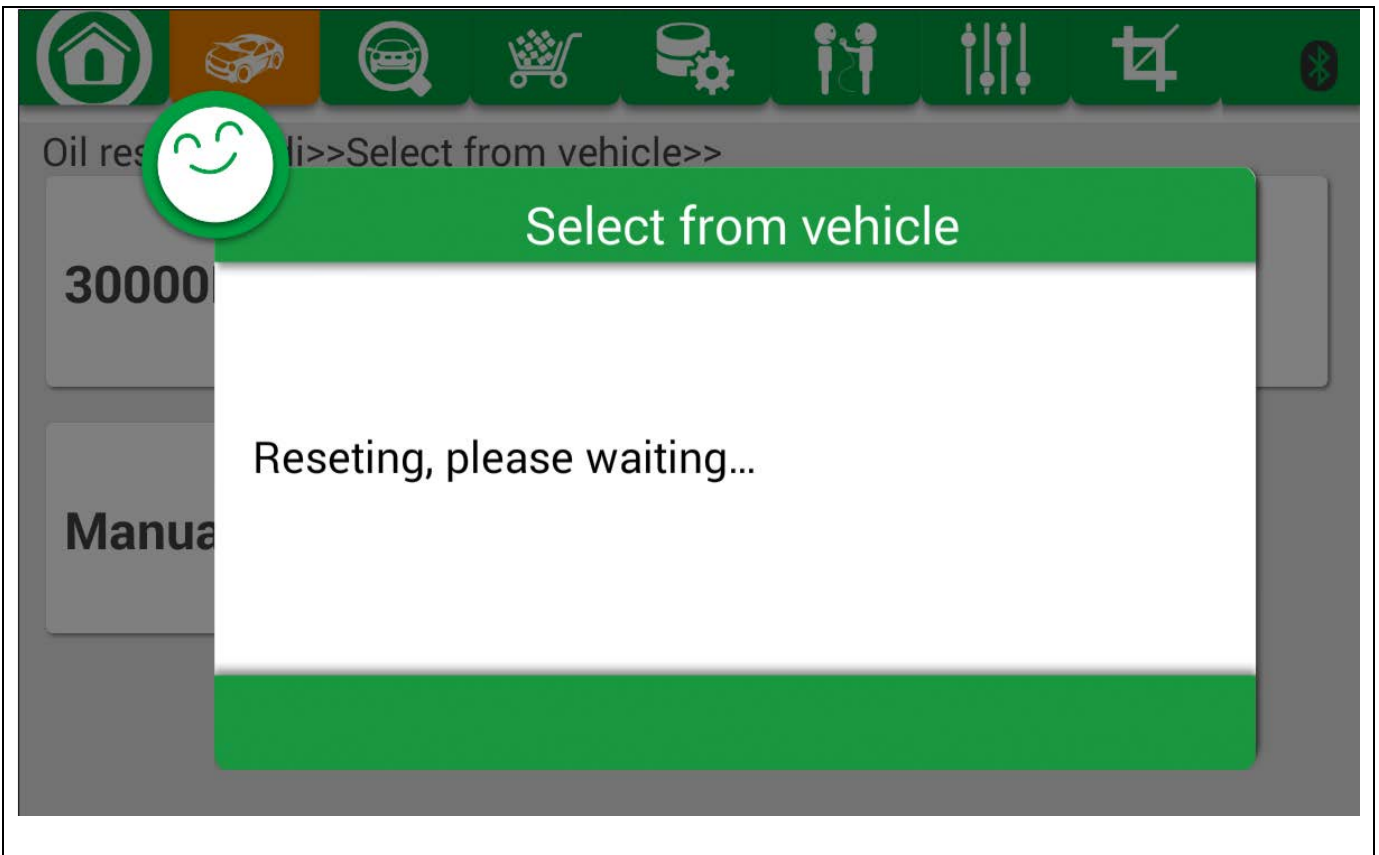
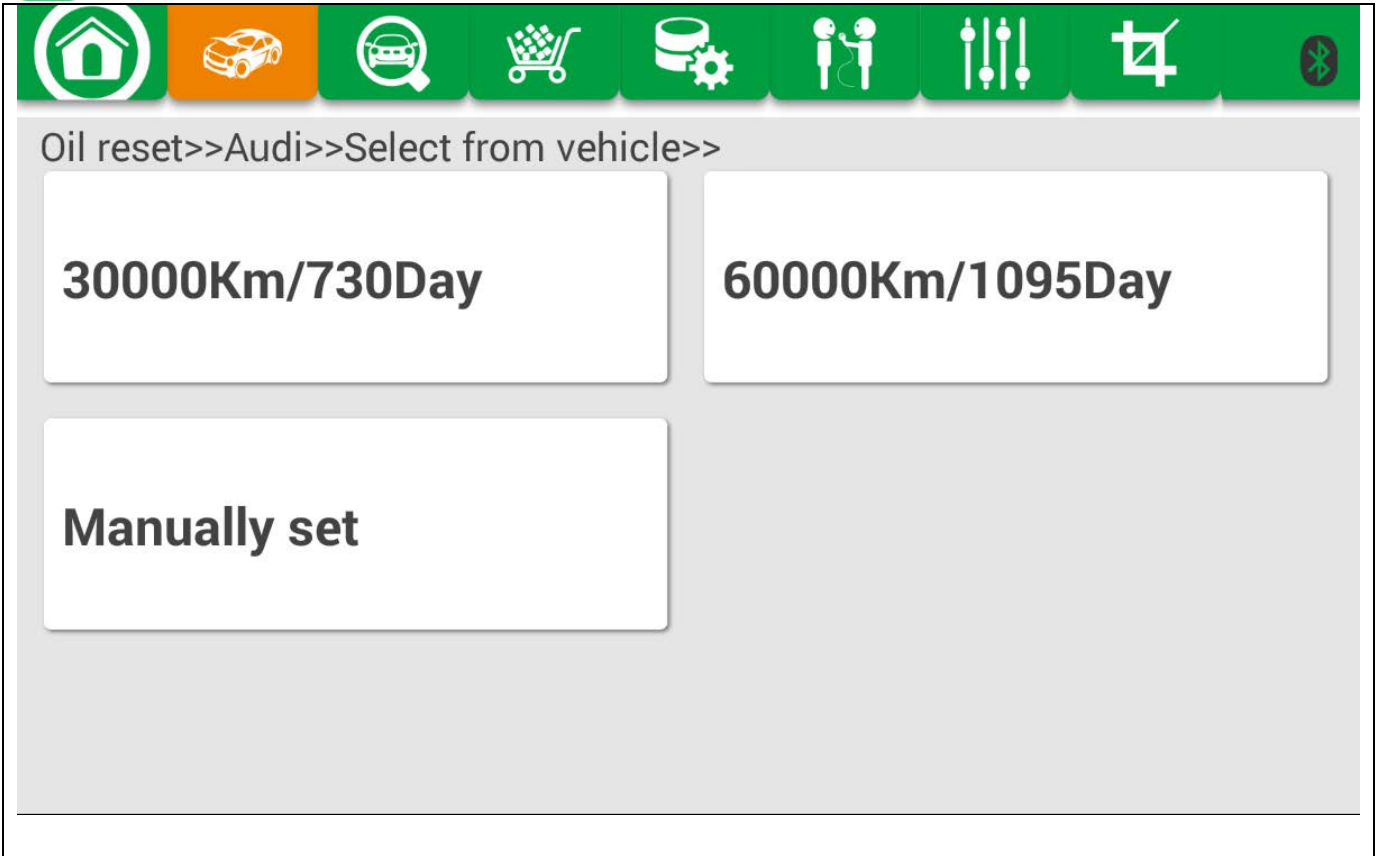

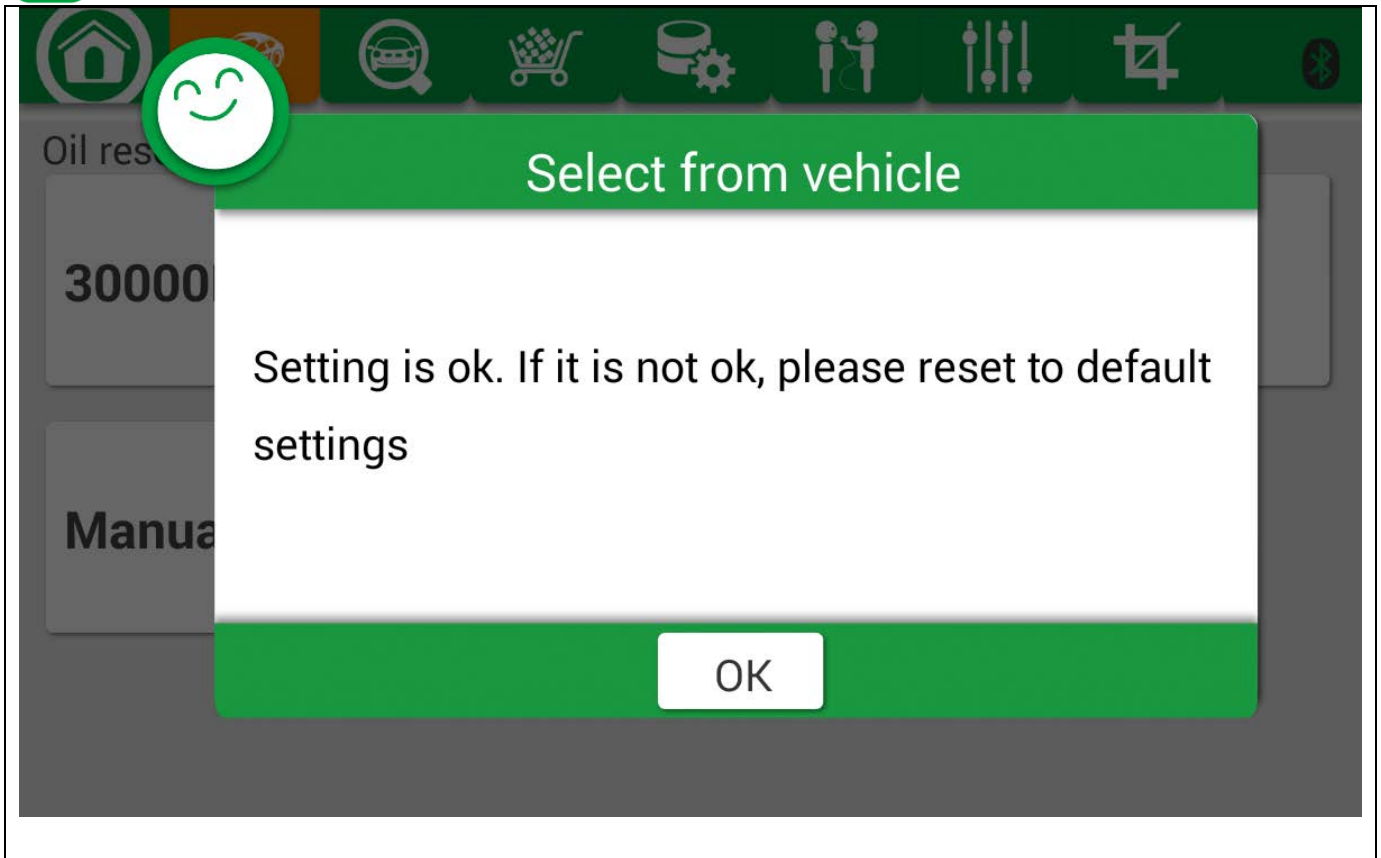











4.6 Feedback

The information of diagnostic software problems can be uploaded to the manufacture by this function. It helps the engineers to fix the bugs quickly.

																	
Subject*	<input type="text"/>	Email*	<input type="text"/>														
App Name*	<input type="text" value="OBDII"/>	Engine Type	<input type="text"/>														
Vehicle Name*	<input type="text"/>	VIN	<input type="text"/>														
Model Year*	<input type="text"/>	Other Info	<input type="text"/>														
Complaint Content*	<input type="text"/>																
																	
(Blanks with *are required.)																	

NOTE: With *, the information is required.

4.7 Data Management

4.7.1 Image Management

Here you can browse or delete the pictures.

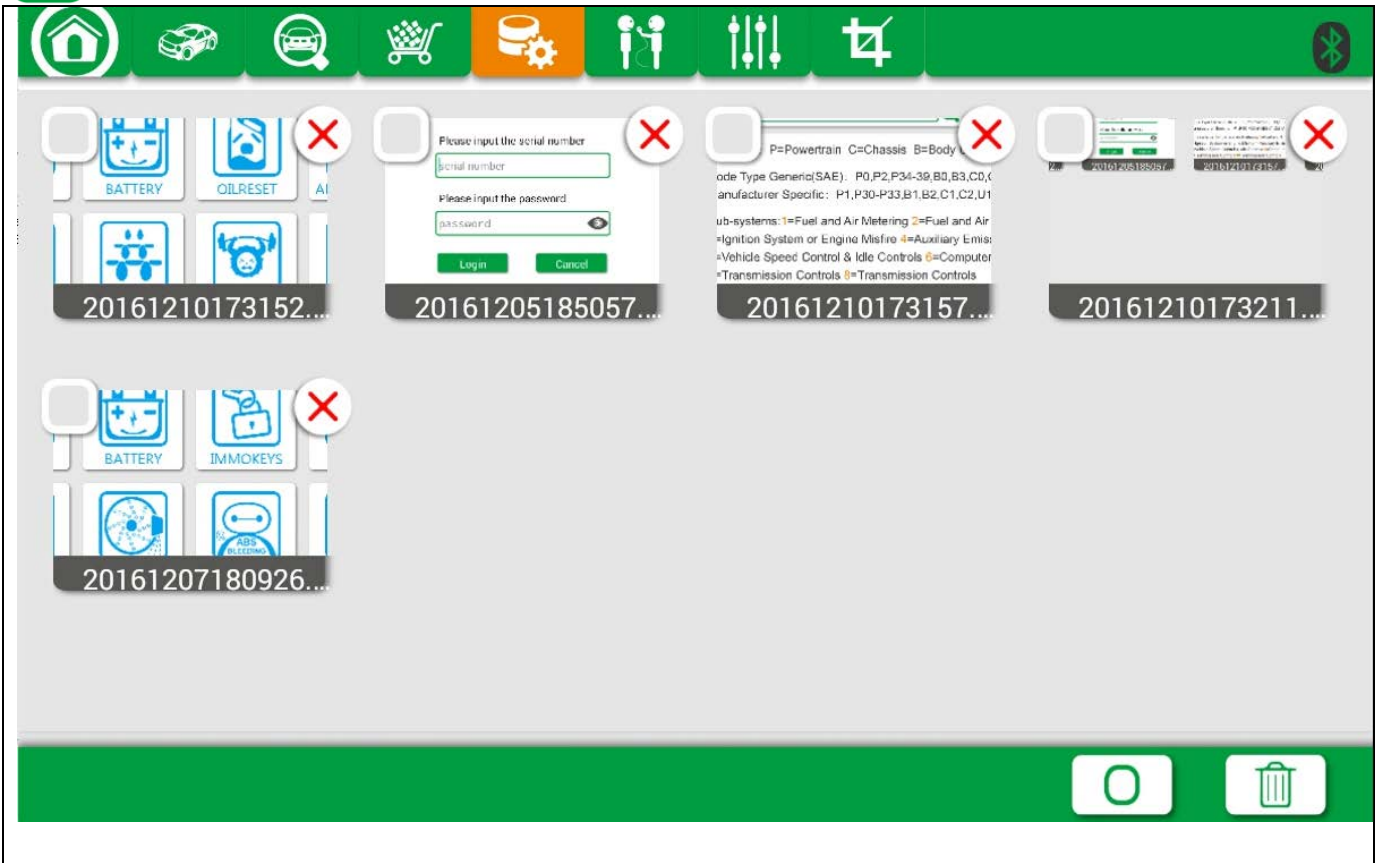

Click the “X” symbol to delete the image.

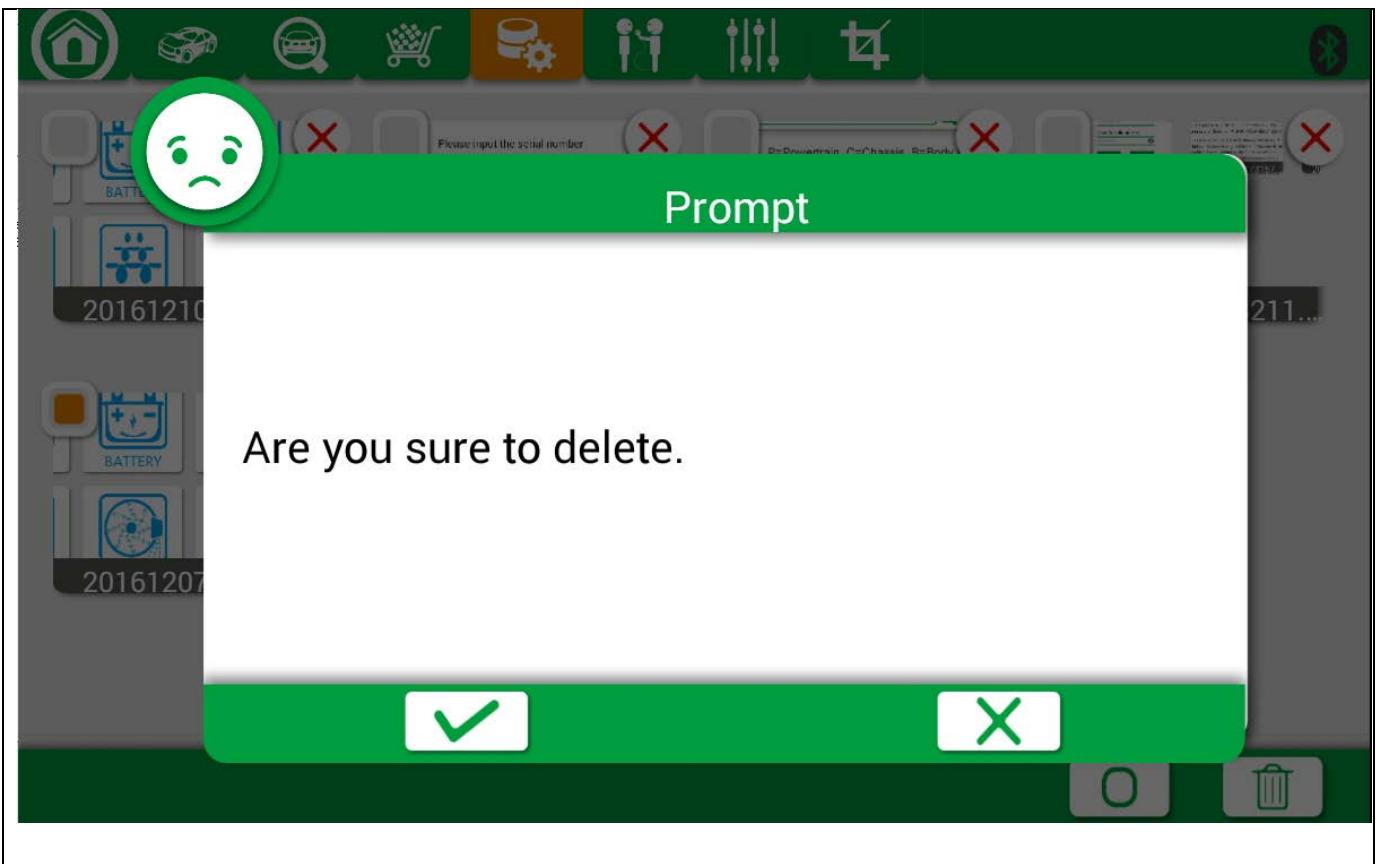

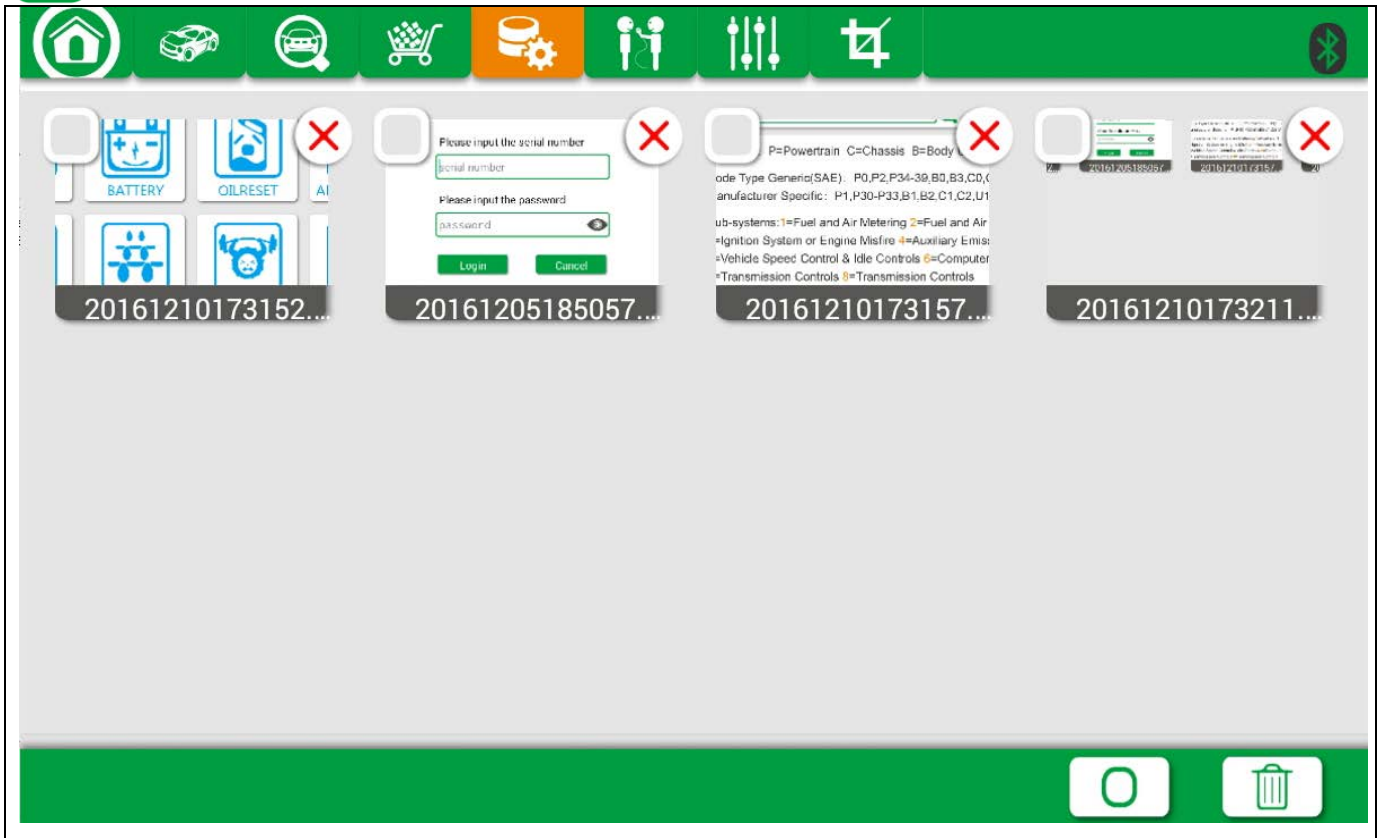

Users can delete the image here, one by one or all-selected delete.

4.7.2 APP Management

Users can delete the diagnostic software here, one by one or all-selected delete.

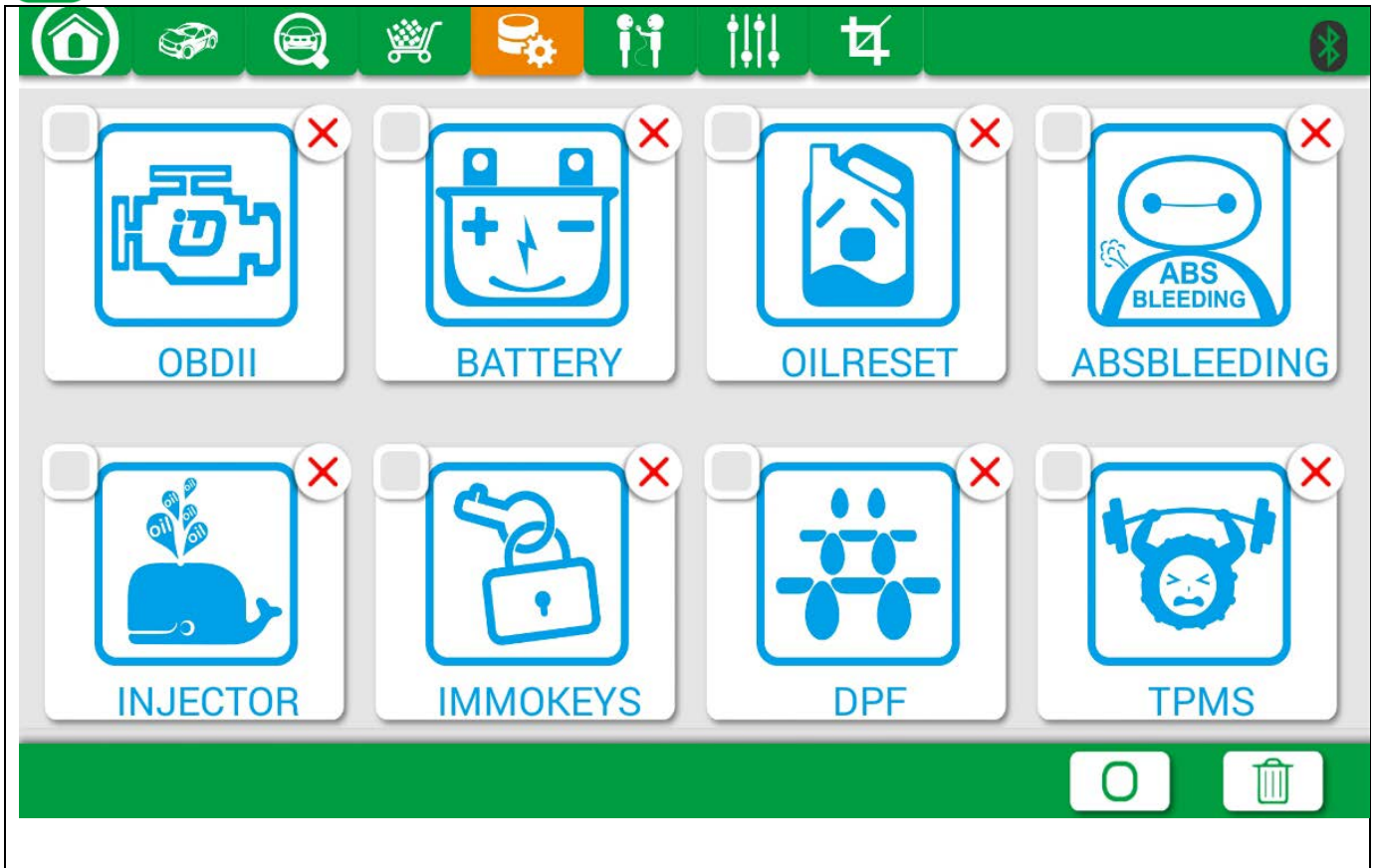

5. Products Website

Please give attention to our website www.tdintel.com for the updating information and other news.

6. Warranty

X500 software is free updating within 1 year from the date of product activation.